

# Assembly Instructions and Owner's Manual

Description:	Wiper Kit for KM-1048-NC Full Size Windshield	Model:	KYMCO, UXV-450
Part Number:	KM-1048-NCWK	Installation Time:	1HR.

## Parts List

Item	Part No.	Description	Qty.	Notes and Tools
1	80-875150-000	Motor Assembly	1	Shown on Page 2
2	80-875152-000	Arm, 12" (30.48cm)	1	" Replacement Arm No. N30910
3	80-875155-000	Blade, 16" (40.64cm), Silicone <b>After Installation, Remove Protective Cover</b>	1	" Replacement Blade No. N30901
4	44-443523-000	Reservoir and Pump Assembly	1	"
5	37-373691-000	Bracket, Tank Hanger	1	"
6	80-830326-000	Wire Harness with Switch	1	"
<b>BAG#1249</b>				
7	80-875156-000	Kit, Spindle Hardware	1	Doga Reference, 100.6469.09.00
8	80-875157-000	Kit, Stud Hardware	1	Doga Reference, 100.6470.09.00
9	44-447167-000	Grommet, Small	1	5/8" (15.24mm) OD
10	44-441927-000	Check Valve	1	
11	44-448726-000	Wire Ties, 7.5" (19.05cm)	10	
12	44-448710-000	Wire Ties, 11 (27.94cm)	2	
13	49-490543-000	Washer, Flat, SS	2	
14	55-562600-000	Screw, #10-32, SS	2	
15	42-450024-000	Nut, Hex, #10-32, Nylok	2	
16	50-505016-000	Screw, Hex, M6-1.0 x 16	4	
17	49-490515-000	Washer Flat, M6	4	
18	42-423039-000	Nut, Hex M6	4	
19	44-449371-000	Clamp, Wrap Around, 1.50" (3.81cm)	1	
20	44-449380-000	Pin, grommet retaining	1	
21	55-563131-000	Screw, #12 x 1.25" SS	1	
22	44-447165-000	Grommet, Large	1	3/4" (19.05mm) OD
23	44-448705-000	Clamp, Cable	1	
24	75-766826-000	Gasket, L= 38.25" (97.15cm)	1	



Spindle Kit



Stud Kit



9 x1



10 x1

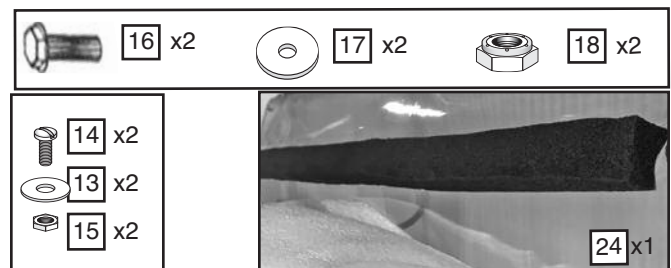

16 x2

17 x2

18 x2

14 x2  
13 x2  
15 x2



24 x1

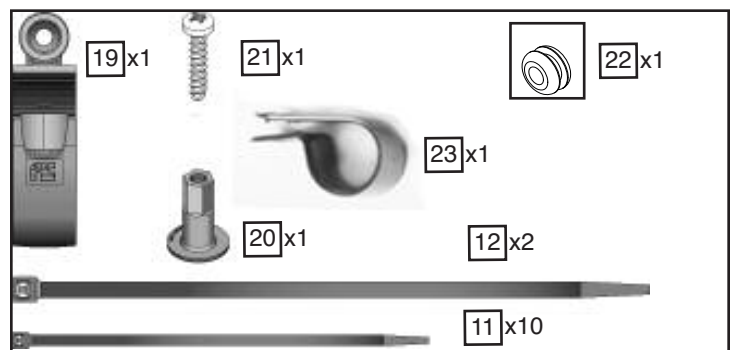

19 x1

21 x1

22 x1

23 x1

20 x1

12 x2

11 x10

**PARTS LIST**

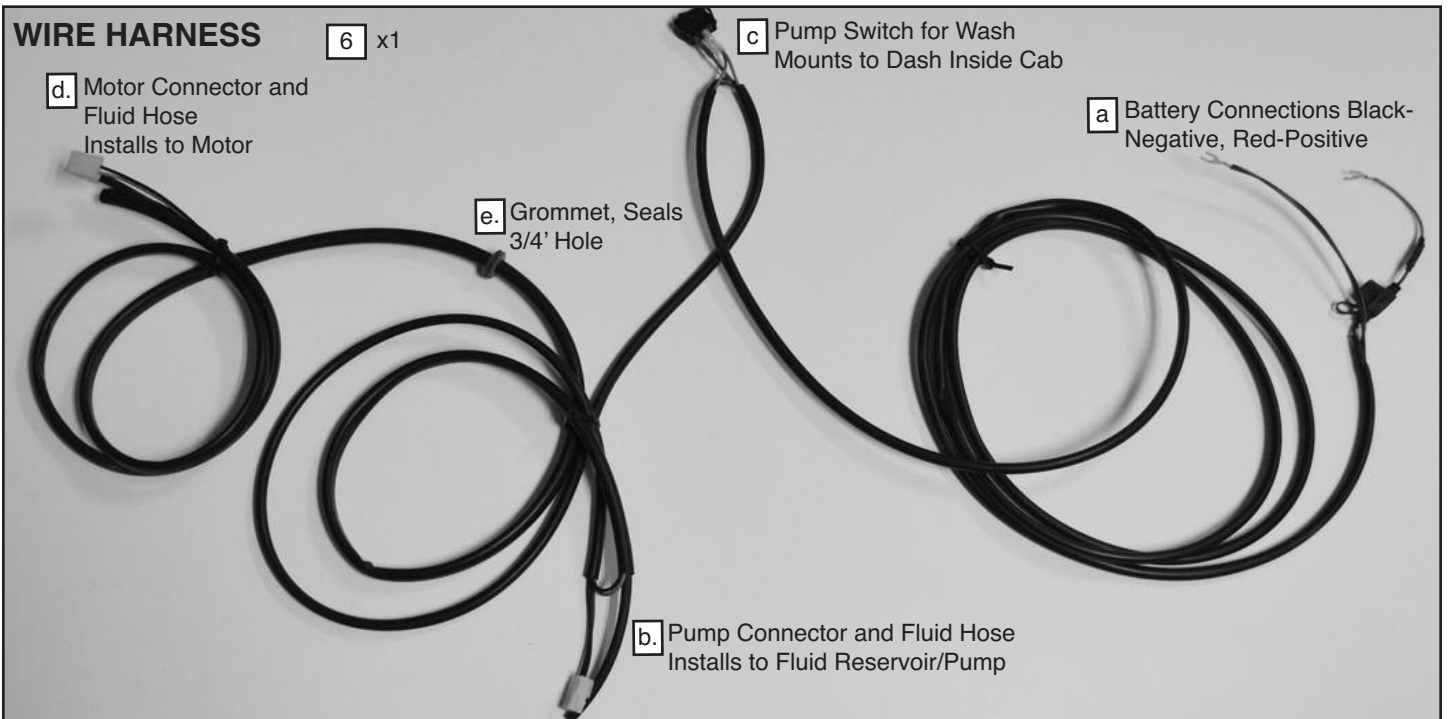
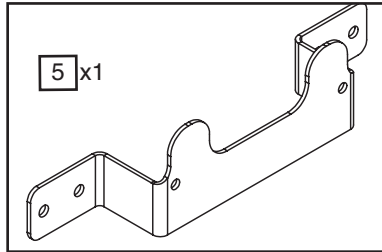
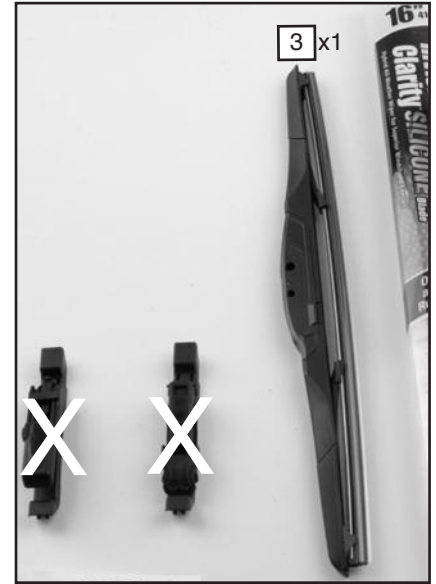
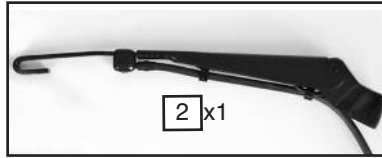
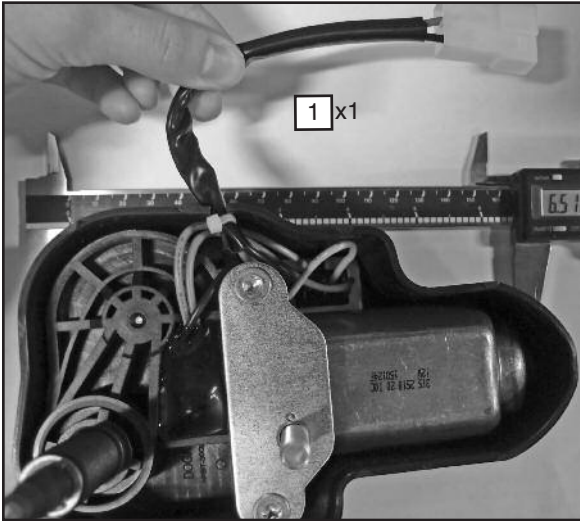

**Tool list**

- Flat blade screwdriver
- Phillips screwdriver
- X-Acto® knife
- Wire cutters
- Power Drill
- Drill bits, 3/4", 1/8" and 1/4"
- Torque wrench, 3 – 16 ft-lbs [4-22 N-m]
- Socket and Wrench Set
- Marker

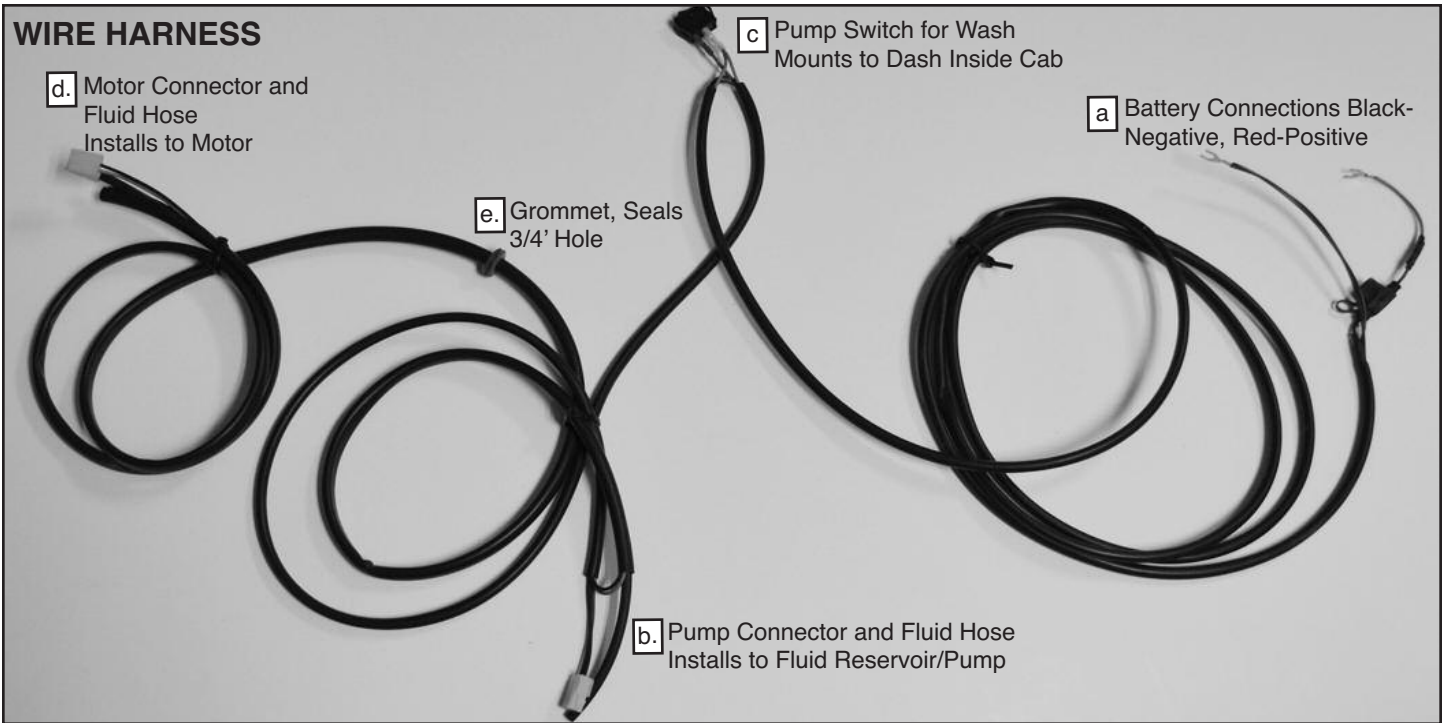

Figure 1

**Installation**

Refer to Figures 1 and 2. Locate a spot to install the harness switch - an open switch bay, or another convenient location.

Locate the section of Wire Harness (c) that terminates in the Two-Way Rocker Switch. Temporarily remove the Rocker Switch.

Scribe or draw a 17/32" x 1-1/8" vertical rectangular guide in the desired location.

Using a 1/8" drill, drill some holes in the plastic cover or dash to serve as starting holes for cutting. Then use your X-acto knife to cut out the opening to the rectangular size. Do Not Over Cut.

Remove the hood panel and set the wiring harness on top of the front storage box. Feed the switch end of the harness under the dash from under the hood, and bring the switch terminals (c) through the hole in the dash. **Figure 2, Inset**

Reconnect the switch to the harness. The wire colors do not matter here. Orient the switch as shown in **Figure 2**. Press the switch into the cut dash hole for a snug fit.

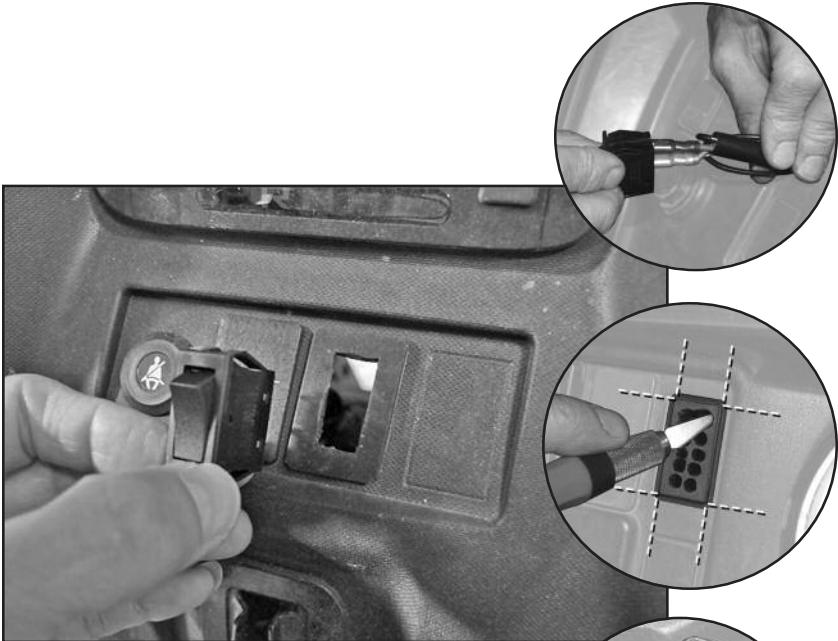

Figure 2



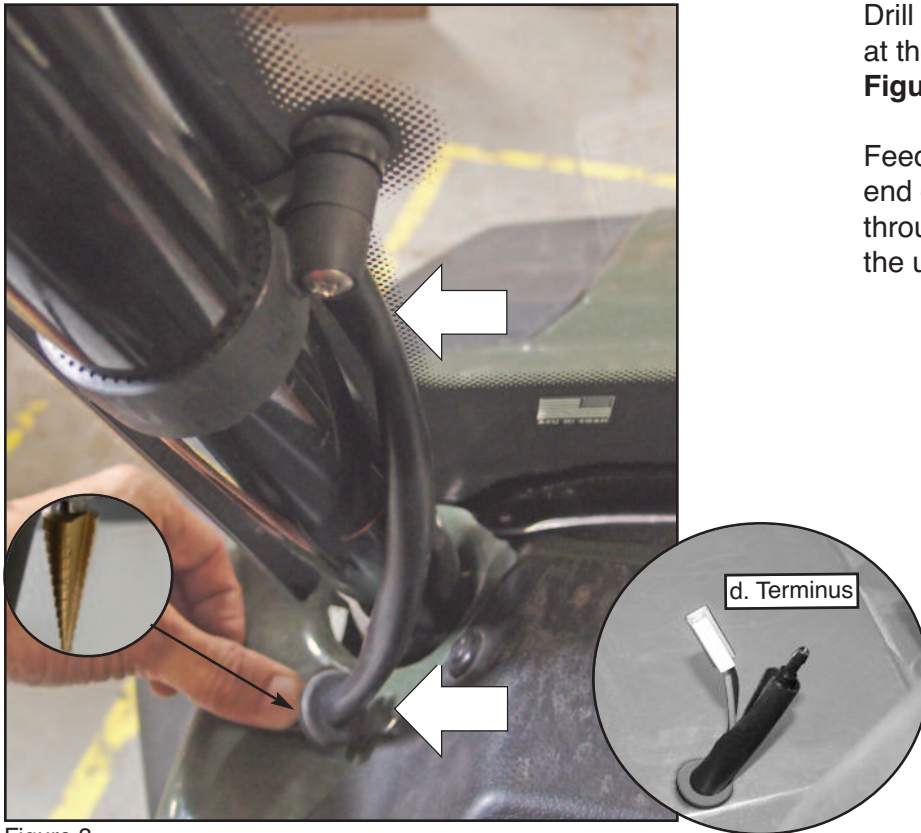

Figure 3

Drill a  $\frac{3}{4}$ " diameter hole through the fender at the location by the lower arrow in **Figure 3**.

Feed the motor connector and fluid hose end of the harness ((d) in **Figure 1**) up through the dash and along the roll bar (see the upper arrow in **Figure 3**, and **Figure 4**).



Figure 4

Continue bringing the motor end up the side and across the top of the roll bar until it reaches almost the middle of the windshield.

Loosen the windshield clamps to fit the harness in the pocket between the clamp, shield and roll bar.

**Do not tighten the clamps at this time.**

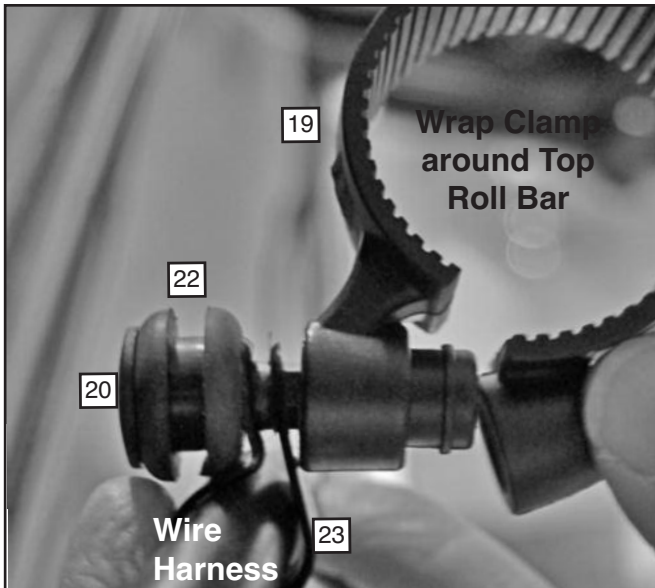

Figure 5

### Upper Harness Support

Attach the 1.5" wrap-around clamp (19) loosely around the top roll bar near the center of the windshield.

Assemble the cable clamp around the harness about 8" from the motor end, and insert the retaining pin (20) through the grommet (22) and cable clamp (23) as shown in **Figure 5**.

Assemble this to the wrap-around clamp with the Phillips screw (21). **Do not fully tighten the screw yet.**

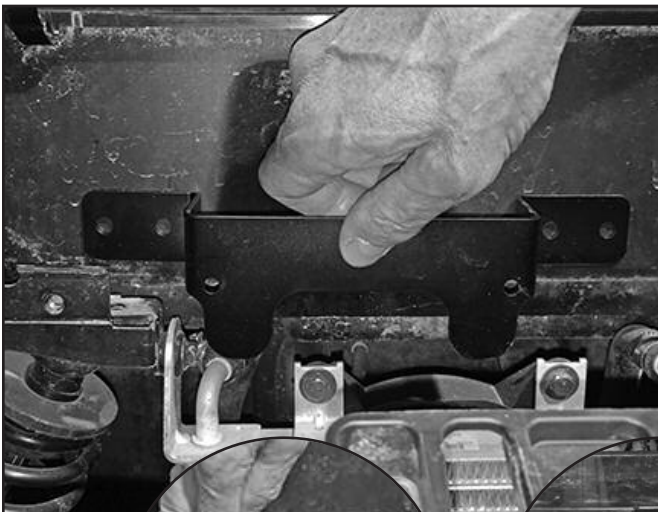

Figure 6

### Fluid Reservoir / Pump

Move to the front of the vehicle. Under the front hood, locate the position for the Reservoir Bracket on the front wall of the storage box as shown in **figure 6**.

Mark the 4 holes. **Figure 6 inset (Marker)**

Drill holes. **Figure 6 inset (Power Drill and 1/4" Drill Bit)**



Figure 7

Attach the reservoir to its bracket using the slotted screws, washers and nuts (13, 14, 15) as shown in Figure 7. Make sure to use the flat washers against the tank flanges. **Figure 7 (Flat Blade Screwdriver)**



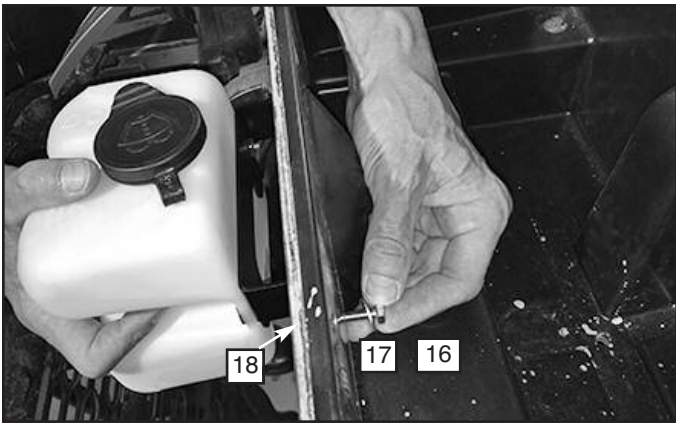

Figure 8

Attach the Reservoir assembly to the front panel of storage box using the Screws, Washers and Nuts (16, 17, 18) as shown in **figure 8. (10mm Socket and Wrench)**

Route the (b) end of the harness around the storage box under the hood on the driver's side to the reservoir and pump.

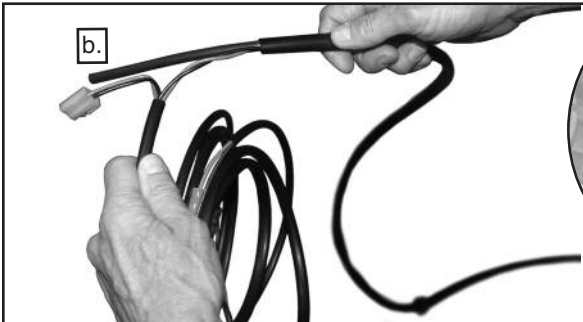

Figure 9

Take Pump Quick Connector section (b) of the Wire Harness and locate the terminus of the Rubber Hose and the Large Nylon 2-Pin Electrical Quick-Connector with red and black wires.

Take the Quick-Connector section and fold it against the Rubber Hose section. Secure the two sheaths with a Zip-Tie (11) and trim the excess. **Figure 9 (Wire Cutters)**

Attach the pump connector and washer fluid tube to the pump. **Figure 10**

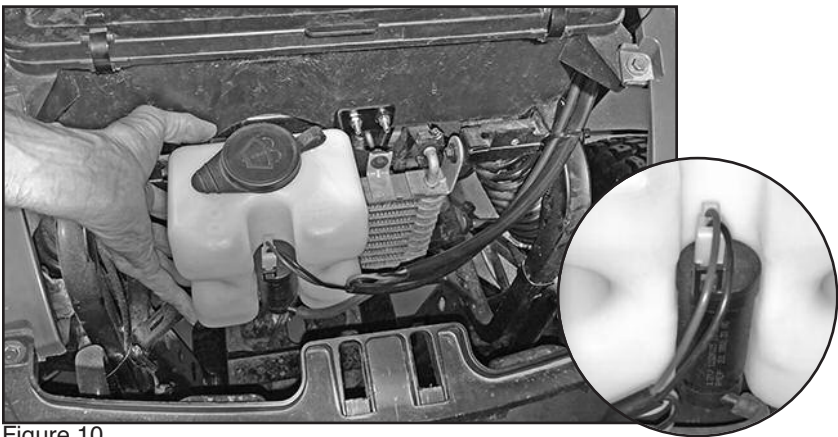

Figure 10

Secure the harness to the vehicle's frame. **Figure 11 (Wire Cutters)**



Figure 11

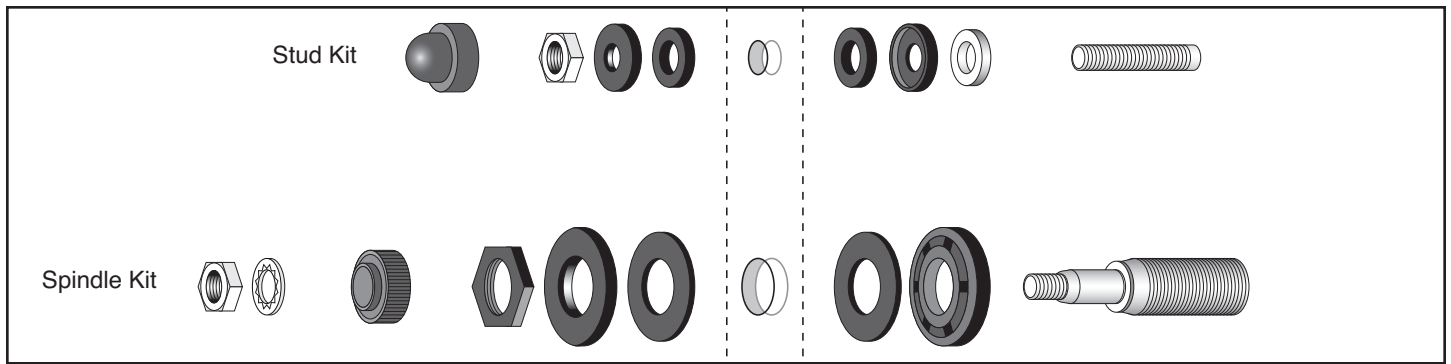

Figure 12

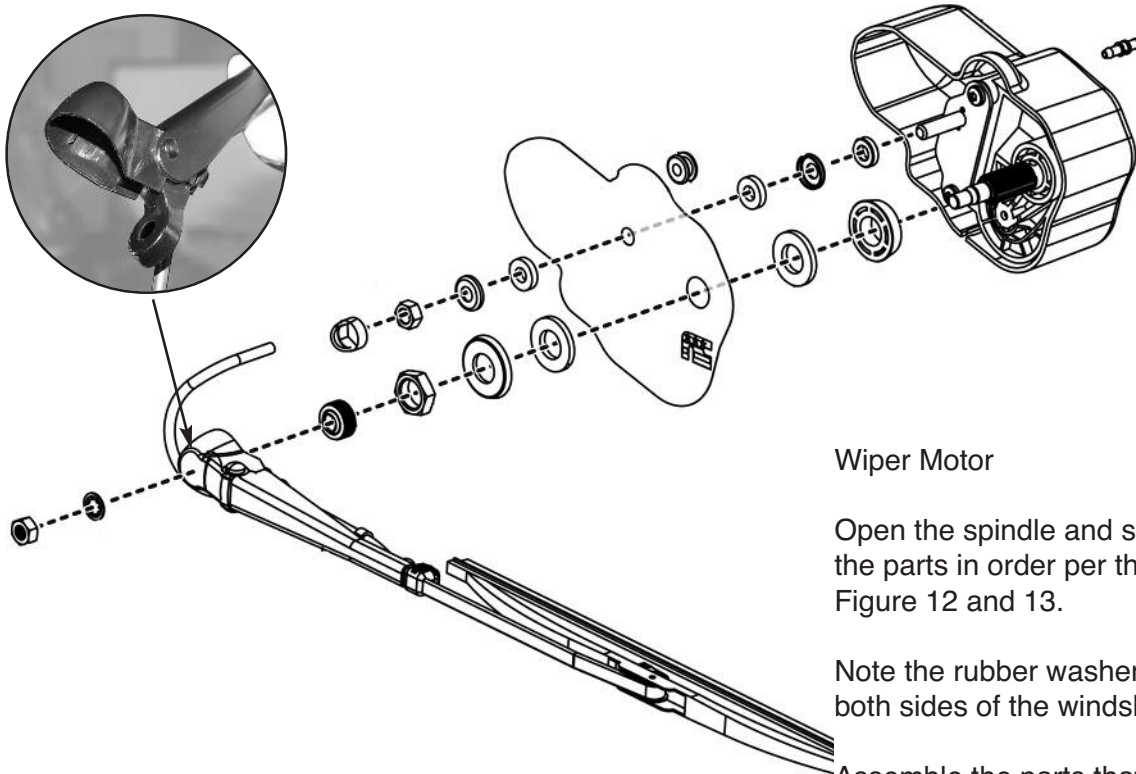

Figure 13

### Wiper Motor

Open the spindle and stud kits and lay out the parts in order per the exploded views, Figure 12 and 13.

Note the rubber washers will go against both sides of the windshield.

Assemble the parts that go **behind** the windshield as shown between the motor and the projected motor outline in the figure.

Remove Plastic Plugs in Windshield for motor to be installed.

Hold the wiper motor up inside the cab and insert the wiper motor shafts through the holes in the windshield per the diagram, and assemble the remaining kit hardware.

The nut on the spindle (larger) shaft needs to be torqued to 4.5 ft-lbs [6 N-m].

The nut on the stud (smaller) shaft needs to be torqued to 3 ft-lbs [4 N-m].

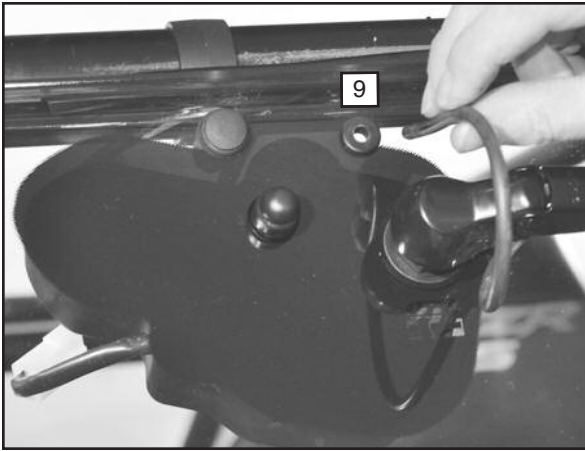

Figure 14

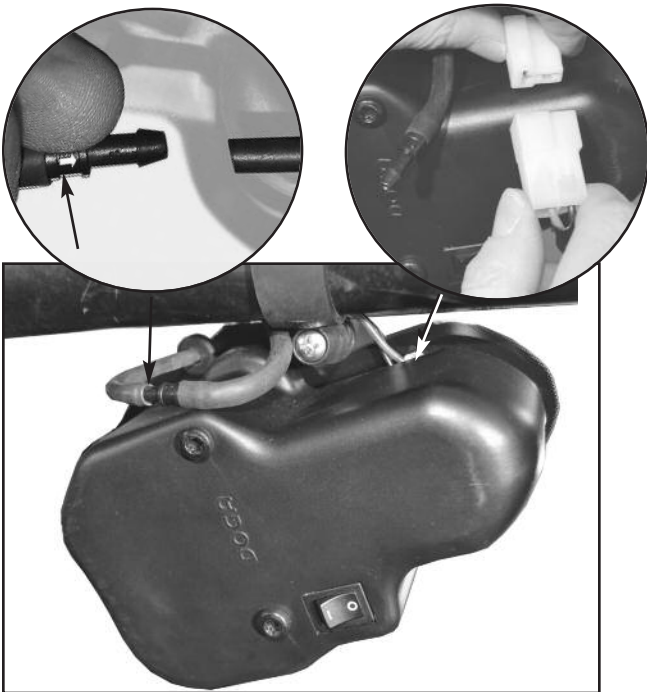

Figure 15

## Refer to Page 10- REPLACING THE WIPER BLADE AND ARM

Assemble the wiper arm (so that it is horizontal on the driver's side), then install its lock washer and nut and torque to 16 ft-lbs [22 N-m].

Close the cover over the nut. **Figure 13**

Install grommet (9) into the hole for the washer hose. **Figure 14**

Route the washer hose in a clockwise semi-circle (for strain relief) and feed the hose through the grommet.

Attach the check valve to the washer hose inside the cab so that its molded-in arrow points in the direction of the arm. **Figure 15**

Note: a little moisture on the hose will aid in insertion.

Connect the motor to the harness and tuck the connector between the motor and windshield. **Figure 15**

Verify that the motor power switch is in the "off" (O) position.





Figure 16

## Finish the Harness Installation

Position the center clamp support in an appropriate position and tighten its screw.

Adjust the slack of the harness across and down the rollbar and tighten the clamps accordingly.

### Attach Battery Terminus (a)

Run the battery end of the harness down behind the dash under the hood and route it through the vehicle's floor tunnel to the battery compartment.

Attach the terminals to the battery, noting the polarity: red and fused is positive.

Secure the harness with zip ties along the way back to the dashboard, being careful to keep the harness away from anything hot, rotating or moving.

Back under the hood, coil the extra harness together and lay it above the glove box. **Figure 17.**

Secure the harness as shown in the figure, then trim the extra length off the zip ties.

**⚠** Do not leave loose Harness anywhere in the vehicle. Once Zip-Tie is tight, clip excess off end. **(Wire Cutters)**



Figure 17

Fill the Reservoir with plain water during warm weather and glycol-based automotive windshield washer fluid in freezing weather.

**⚠** DO NOT run the pump dry. Minimum amount of fluid to maintain in the Reservoir is:

12 oz. (.35L) or to a depth of 1 1/2" (38mm)

Minimum depth of 1 1/2" -----





Figure 18

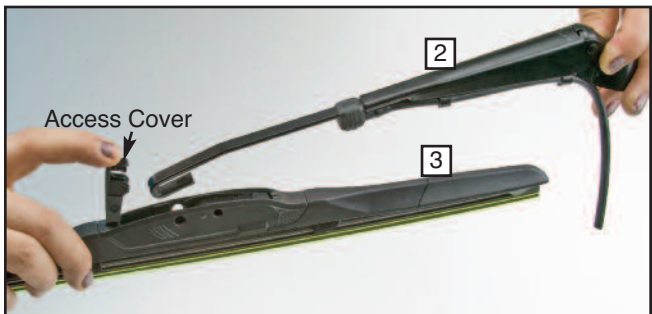

Figure 19

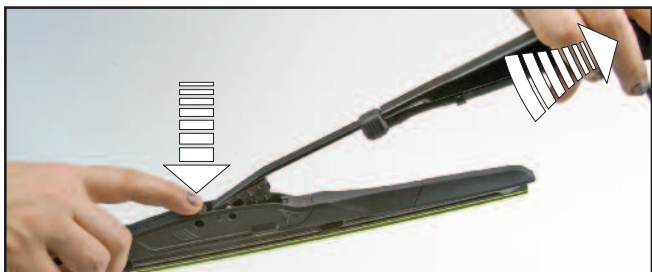

Figure 20



Figure 21



Figure 22

## WINDSHIELD WIPER OPERATION



The Wiper is intended for use with the wash cycle or during rain. **DO NOT** Wipe a dry windshield.

**DO NOT** run the Pump without fluid.

**REMOVE** protective Cover from Wiper Blade before use. **Figure 18**

The Wiper Motor has an on/off Rocker Switch as shown. Turn the switch on and verify that the Wiper works as expected.

The dash panel Rocker Switch installed controls the fluid spray. Momentarily hold the Switch in the on position to spray water from the Wiper Arm. It should spray in four separate directions.

## WIPER ARM AND BLADE

Your Wiper Kit is equipped with a quality silicone Wiper Blade. Replacement Wiper Blades are available from your local dealer or by contacting National Cycle.

**Replacement Wiper Blade Part Number is N30901 Replacement Wiper Arm Part Number is N30910**

## REPLACING THE WIPER BLADE AND ARM

Open the small access cover on the Wiper Blade (3) and pull the blade towards the motor end of Wiper Arm to loosen blade. **Figure 19**

Join the end of the Wiper Arm (2) to the Wiper Blade (3). Place the J-hook of the Arm over the Blade's plastic mounting clip until it clicks and locks into place. Close the small access cover. **Figure 19 and 20**

Swivel up the mount cover of the Wiper Arm as shown and then mount the Wiper Arm over the Motor's Spindle. **Figure 21**

Once the Wiper Arm is on the Spindle, install the Internal Tooth Lock Washer and Small Mounting Nut. Use a torque wrench to tighten the Small Mounting Nut to 16 foot-pounds (22Nm). Then swivel the mount cover of the Wiper Arm back to its closed position. **Figure 22 (Torque Wrench with 13 mm Socket)**

## CLEANING AND MAINTENANCE

To clean the screen, wash with a clean soft cloth, plenty of warm water and if necessary, a non-abrasive soap such as dishwashing liquid. Flannel or soft chamois make good cleaning cloths. **Paint, glue residue or grease removal:** Moisten cotton with naphtha or turpentine followed by a wash as above.

Do not clean polycarbonate in hot sun or high temperatures. Do not clean the screen with glass cleaners.

Do not allow brake fluid, alcohol, or strong solvents to contact the screen.

### **WARNING**

Never operate your vehicle with loose accessory mounting hardware. Check the hardware for tightness regularly.

UTVs are built with enough frame rigidity to withstand the moderate loads imposed on them by the foreseeable addition of an accessory(ies). If an accessory(ies) adversely affects your vehicle's stability, immediately remove the accessory(ies). Do not operate a vehicle that exhibits unsafe handling traits.

Have experienced service personnel correct any problem before driving with the accessory(ies) installed. For further questions concerning handling problems associated with an accessory(ies), contact your dealer, UTV manufacturer, or accessory manufacturer.

**CAUTION:** Do not clean polycarbonate in hot sun or high temperatures. Do not clean the screen with glass cleaners. Certain chemicals, generally known as acidic hydrocarbons, are known to cause polycarbonate damage. Do not allow brake fluid, alcohol, or strong solvents to contact the screen.

**CAUTION:** Do not use rain protective products made for glass. We recommend National Cycle's **RainZip®** (N1410-01) to help shed water in rainy weather.

**CAUTION:** Always face windshield forward (in direction of travel) while carrying on truck or trailer.

Do Not Wipe Windshield when it is dry, Wash, then Wipe.

Remove protective cover from Wiper Blade before use.