

**PARTS LIST**

| <u>Qty.</u>     | <u>Index</u>                           | <u>Description</u>  | <u>Re-Order No.</u> | <u>Qty.</u> |
|-----------------|--|---------------------|---------------------|-------------|
|                 | 1                                      | Fairing Body        |                     | 1           |
|                 | 2                                      | Windshield          | 20-260010-000       | 1           |
|                 | 3                                      | Upper Arm           | 34-344144-000       | 2           |
|                 | 4                                      | Lower Rod, Left     | 34-344142-000       | 1           |
|                 | 5                                      | Lower Rod, Right    | 34-344143-000       | 1           |
| <b>Bag 136A</b> |  |                     | <b>Bag 136A</b>     |             |
|                 | 7                                      | Eyebolt, 7/16" Hole | 52-521030-000       | 4           |
|                 | 8                                      | Cup Spacer          | 49-496110-000       | 4           |
|                 | 9                                      | Lock Washer         | 49-492310-000       | 4           |
|                 | 10                                     | U-Clamp             | 37-420110-000       | 2           |
|                 | 11                                     | Bevel Washer        | 49-493110-000       | 8           |
|                 | 12                                     | Whizlok Nut, 3/8-16 | 42-432010-000       | 4           |
| <b>Bag 334</b>  |  |                     | <b>Bag 334</b>      |             |
|                 | 13                                     | 10-32 x 5/8" Screw  | 50-530400-000       | 8           |
|                 | 14                                     | Whizlok Nut         | 42-439010-000       | 7           |
| <b>N6170</b>    | <b>Mirror Assmely Includes Bag 332</b> |                     | <b>N6170</b>        |             |
|                 | 13                                     | Mirror, Left        | 60-600700-000       | 1           |
|                 | 14                                     | Mirror, Right       | 60-600701-000       | 1           |
| <b>Bag 332</b>  |  |                     | <b>Bag 332</b>      |             |
|                 | 15                                     | 10-32 x 3/4" Screw  | 55-562211-000       | 4           |
|                 | 16                                     | Acorn Nut           | 42-480201-000       | 4           |
|                 | 17                                     | Flat Washer         | 49-490110-000       | 4           |

**MAINTENANCE**
**MAINTENANCE**

To clean the screen, wash with a clean soft cloth, plenty of warm water and , if necessary, a non-abrasive soap such as dishwashing liquid. Flannel or soft chamois make good cleaning cloths. Rinse well to remove all soap residue. Pat dry, do not wipe.

Remove paint, grease or glue residue with naphtha or turpentine, follow with wash as described above.

**PRECAUTIONS**

Never ride you ATV with loose fairing mounting hardware. Check the hardware for tightness regularly. Have experienced service personnel correct any problems before riding with this fairing installed.

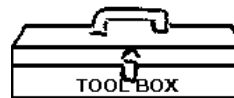

9/16" Wrench  
Flat Head Screw Driver

**NOTE:** Right and Left side of ATV is determined while sitting on the vehicle.

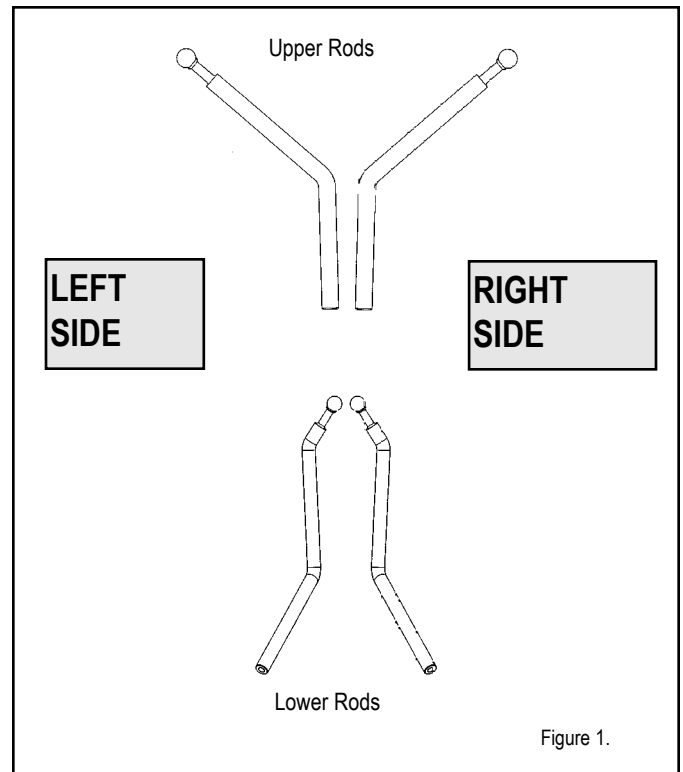
**INSTALLATION**

1. Identify upper arms and left and right lower rods. Figure 1.

**INSTALL UPPER AND LOWER RODS**

Figure 2.

2. Support the mounting receptacle of the Fairing Body on a firm, flat surface, and firmly press ball end of upper arms (3) into upper sockets. Ball will snap into place. Repeat for lower arms (4&5).

**NOTE:** If sockets are below 50° F., warm them with a hair dryer before installing arms. If lubricant is needed, use water or saliva only. Do not use oil, grease, silicone or other lubricants on the ball end rods or in the mount receptacles.

## INSTALL FAIRING TO ATV

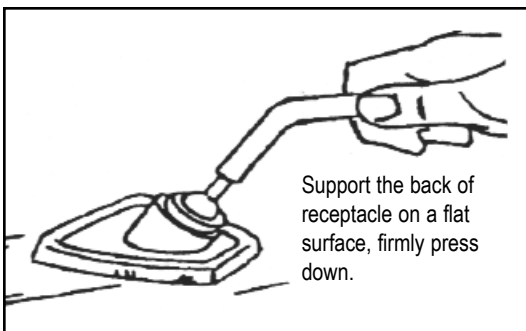
LEFT

RIGHT

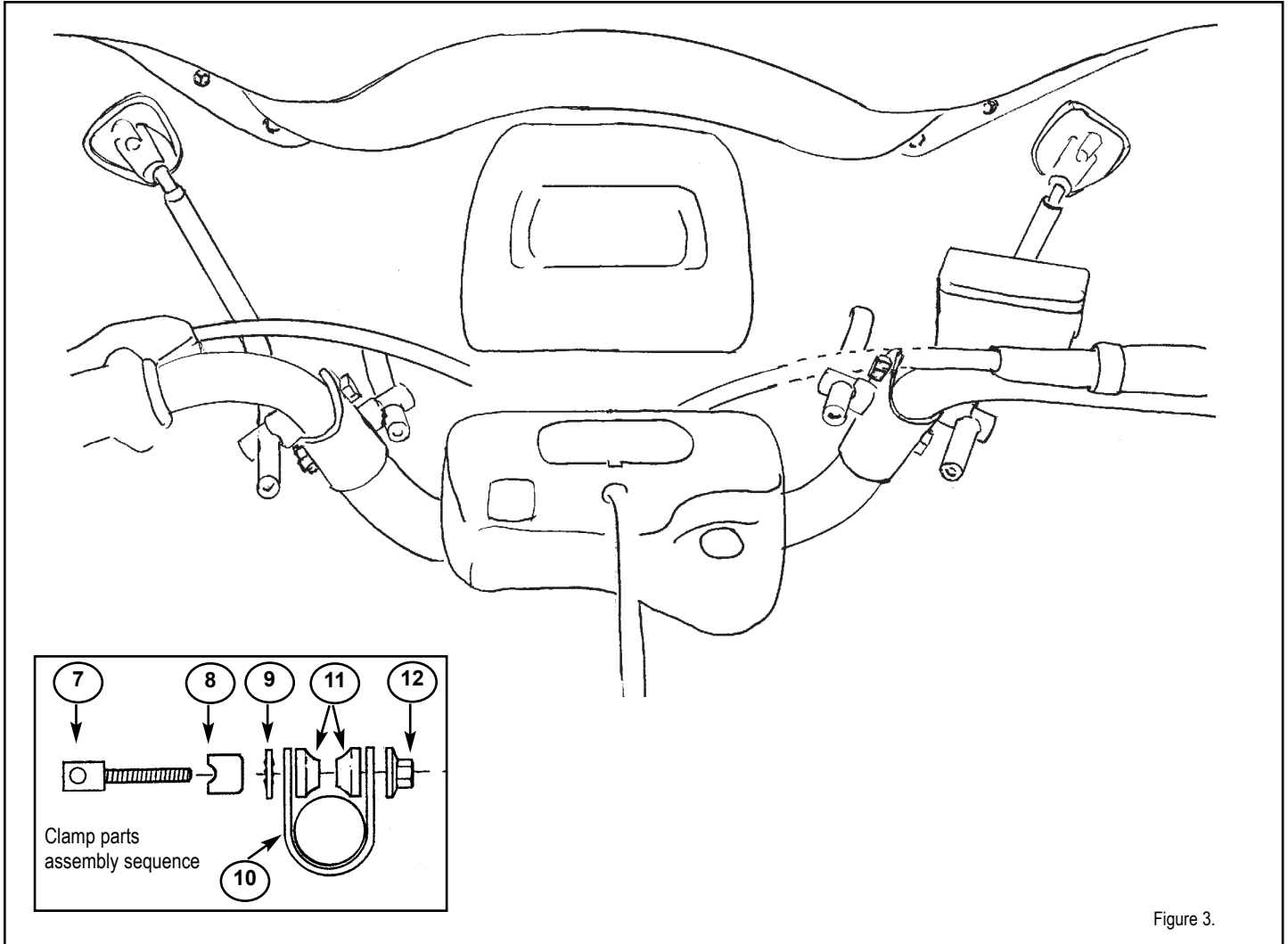

Figure 3.

**3.** Install left side clamp assembly as shown. Install right side symmetrically opposite.

**4.** Mount fairing body in front of handlebar. Insert upper and lower arms into eyebolts as shown in figure 3. Adjust the fairing body to align with opening of headlight. Make sure the brake levers have a minimum 1/2" clearance to the fairing body. Firmly tighten the eyebolt and whizlok nuts, checking fairing body alignment while proceeding.

### **5. Install Windshield Hardware Bag 334**

**A.)** Hold Windshield in place on the Fairing body.

**B.)** Start with the middle lower hole and insert a nylon screw through the screen from the outside. Secure with the whizlok nut.

### **6. Install Mirrors Hardware Bag 332**

**A)** From inside the fairing body install a mirror with flat washer and screw. Secure with whizlok nut on the outside of fairing.