

Attention



Special notes and cautionary measures which can prevent damage to the accessory or motorcycle.

Note:



Tips for facilitation of operation, control and adjustment, as well as maintenance work.

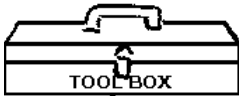

TOOLS REQUIRED

- Phillips Screw Driver (FLT 1989-96)
- Small Flat Blade Screwdriver (to remove well-nut)

PARTS LIST for VStream N20421 - N20425

Part No.	Description	Qty.
	Windshield, Quantum Hardcoated polycarbonate	1
BAG 975		
44-447158-000	Grommet	5
49-495670-000	Bushing	5

PREPARATION



To install N20427 or N20430 to the FLT 1989 - 96 proceed to page 3.



Retain all fasteners and parts as they will be reused. Windscreen mount hole in fairing body is oversized. When removing and installing windscreen use care to prevent stock well-nut from falling into fairing body.

1. Remove the stock screws and washers that hold the wind screen in place on the fairing. **(Phillips Screw Driver)**
- 2 Remove stock windscreen.
3. Remove gasket from stock windscreen.

INSTALLATION OF VSTREAM® WINDSCREEN

1. Using the grommets supplied in Bag 975 insert one Grommet into each windscreen hole. **Figure 1**



Compression Limiter is inserted into wind-screen hole from the INSIDE.

2. Insert one compression limiter into hole so flanged area of compression limiter is flush against grommet on **INSIDE** of windshield. **Figure 2**

3. Install trim gasket onto windshield. **Figure 3**



Figure 1

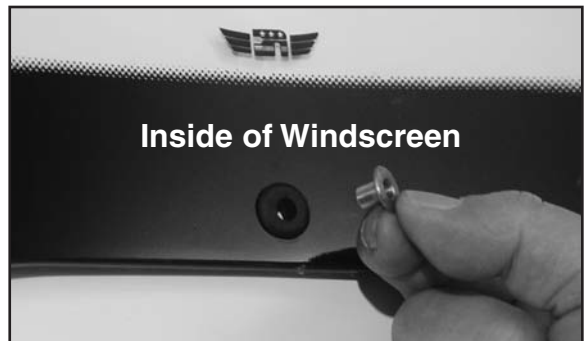

Figure 2



Figure 3



Removing well-nut as instructed below will prevent nut from falling into fairing body during installation.

4. Carefully remove the stock well-nuts from fairing body.
Figure 4

5. Assemble the stock washer onto the screw. Insert assembly through hole in windscreen and start well nut.
Figure 5

6. Position the windscreen on fairing body. Start at one end and press well-nuts into holes in fairing.
Figure 6

5. Tighten screws firmly, do not overtighten. (**Phillips Screwdriver**) **Figure 7**

7. Refer to the 3 year unbreakable warranty on page 4 to register your windshield.

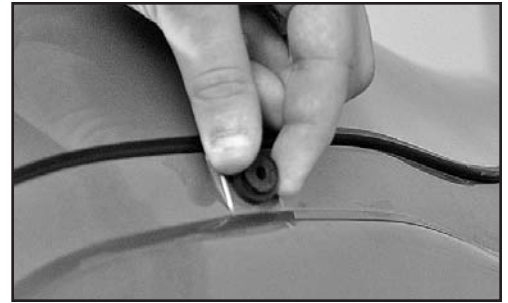

Figure 4

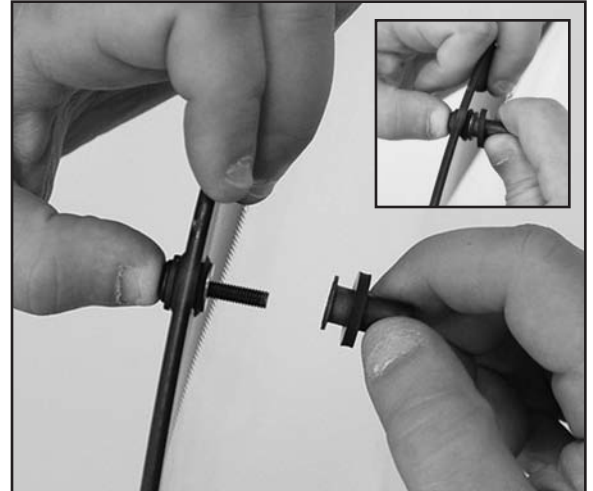

Figure 5



Figure 6



Figure 7

PARTS LIST for VStream N20427 - N20430

Windshield, Quantum Hardcoated polycarbonate 1

BAG 976

44-447158-000 Grommet 7
49-495670-000 Bushing 7

FLT Tour Glide 1989-96 INSTALLATION

PREPARATION

1. Remove the 7 screws and washers holding the stock windshield in place. **(Phillips Screw Driver)**

2. Remove stock windshield.

INSTALLATION OF VSTREAM® WINDSHIELD

1. Using the grommets supplied in Bag 976 insert one grommet into each windshield hole. **Figure 1, page 1**

 **Compression Limiter is inserted into windscreen hole from the INSIDE.**

2. Insert one compression limiter into hole so flanged area of compression limiter is flush against grommet on **INSIDE** of windshield. **Figure 2, page 1**

3. Install VStream windshield to motorcycle using the stock screws and washers. **(Phillips Screw Driver)**

4. Tighten fasteners, do not overtighten.

5. Refer to the 3 year unbreakable warranty on page 4 and register your windshield.

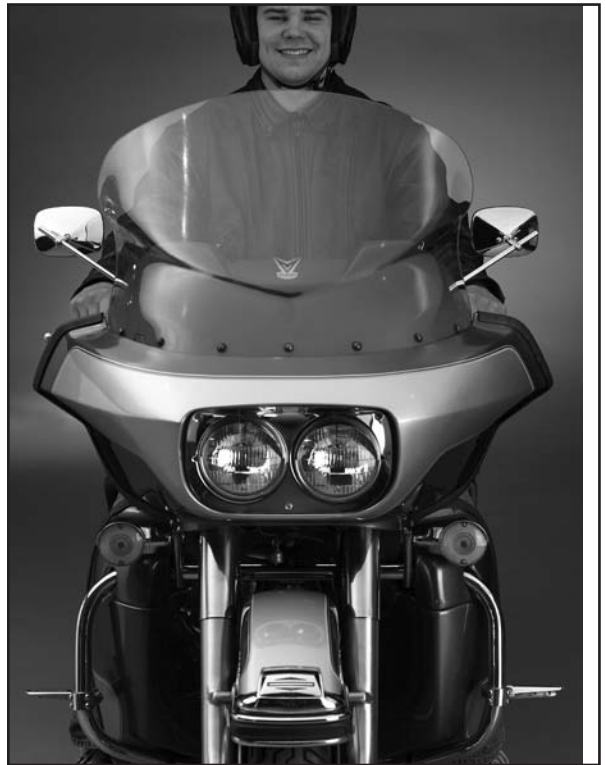

MAINTENANCE

Cleaning: Wash with a clean soft cloth, plenty of warm water and, if necessary, a non-abrasive soap such as dishwashing liquid. Flannel or soft chamois make good cleaning cloths. Do not use rain protective products on the screen due to the solvent action of the alcohol in these products. Do not allow brake fluid, alcohol, or strong solvents to contact the screen.

National Cycle Windshield Wash Part number N1401 is recommended for everyday cleaning. Product is supplied with a handy travel size container and rag for easy storage on the motorcycle. Inquire with your local dealer or visit: www.nationalcycle.com

RainZip®

National Cycle offers RainZip, rain repellent treatment. RainZip is a hydrophobic treatment. When water hits the surface of the windscreen it beads up, so at 40 mph the wind pushes the water off. RainZip is formulated at National Cycle for our Quantum Hardcoated polycarbonate windscreens but is safe for all windshields. RainZip comes in a 3-oz. bottle and includes an application cloth and micro fiber polishing cloth. **RainZip- N1410-01**

The time in which you will need to reapply this coating will depend on riding conditions. If you use your bike regularly after about 2-3 months you may notice the treatment not working as effectively. When this happens, first clean your windshield thoroughly, then buff with a micro fiber soft cloth or unused soft chamois. Buffing the windshield will “re-new” the RainZip® treatment. Or you may wish to reapply the treatment. One 3-oz. bottle will provide several treatments.

VStream® Wind protection products are covered by patent 7,387,328.

VStream® and National Cycle® are registered trademarks of National Cycle, Inc.

	<p>National Cycle 3-Year Limited Warranty Register your windshield on Line at: www.nationalcycle.com/register.html or contact Customer Service at National Cycle, Inc. / PO Box 158 / Maywood, IL 60153 / USA 708/343/0400</p> <p>National Cycle hereby warrants to the original registered owner of a National Cycle polycarbonate windshield for a period of three years from the date of purchase against breakage. This limited warranty is expressly limited to the replacement of the polycarbonate windscreen. This limited warranty does not include scratches, coating failure, cosmetic wear and tear, replacement of hardware, or any consequential damages or expenses including labor cost of installation, removal and/or replacement, inconvenience, inbound freight expenses or damage to any other component of the motorcycle or any other accessories. Certain chemicals, generally known as acidic hydrocarbons, are known to cause polycarbonate damage and will not be covered under this limited warranty. Please refer to the cleaning instructions supplied with all National Cycle windshields.</p>
--	---

WARNING

Never ride your motorcycle with loose accessory mounting hardware. Check the hardware for tightness regularly.

Today's motorcycles are built with enough frame rigidity to withstand the moderate loads imposed on them by the foreseeable addition of an accessory(ies). If an accessory(ies) adversely affects your motorcycle's stability, immediately remove the accessory(ies). Do not ride a motorcycle that exhibits unsafe handling traits.

Have experienced service personnel correct any problem before riding with the accessory(ies) installed. For further questions concerning handling problems associated with an accessory(ies), contact your dealer, motorcycle manufacturer, or accessory manufacturer.