

Dealers: If installing the windshield for a customer please give them this manual. It contains information needed to properly maintain and use this product.

Attention:



Special notes and cautionary measures which can prevent damage to the accessory or motorcycle.

Note:



Tips for facilitation of operation, control and adjustment, as well as maintenance work.

Parts List for Kit GB

| <u>INDEX</u> | <u>DESCRIPTION</u> | <u>QTY.</u> |
|----------------|--|-------------|
| 1 | 20-202053-000 Windscreen, N20240 | 1 |
| 2 | 37-370732-000 Mount Bracket, Left | 1 |
| 3 | 37-370733-000 Mount Bracket, Right | 1 |
| BAG#894 | | |
| 4 | 75-764010-000 Clamp Spacer, Rubber Strip | 2 |
| 5 | 49-495413-000 Cap, Head | 4 |
| 6 | 44-447304-000 Grommet | 4 |
| 7 | 51-514516-000 CS, Flat HS 10-32 x 5/8" | 4 |
| 8 | 37-371122-000 Clamp, Black Outer | 2 |
| 9 | 51-515721-000 CS, HS M8 x 20 | 2 |



6mm Socket or Hex Wrench
12mm Box Wrench
6, 5 and 3mm Hex Key
Silicone Lubricant (if required,
step 3, page 3)

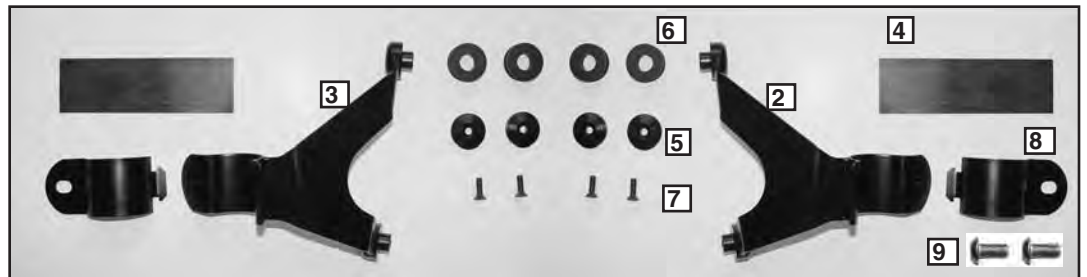

PREPARATION



Position the motorcycle securely on its stand or a work stand. Cover the front fender and fuel tank with a cloth to avoid scratches from dropped tools.

1. Identify left from right Mount Brackets. **Figure 1**

2. Cut each of the clamp spacers (4) in half to make 4 pieces.

3. Apply one spacer to the inside of each mount bracket. **Figure 2**

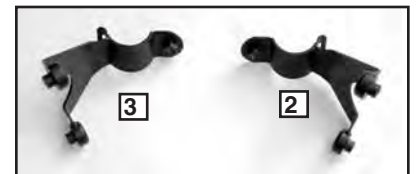

Figure 1

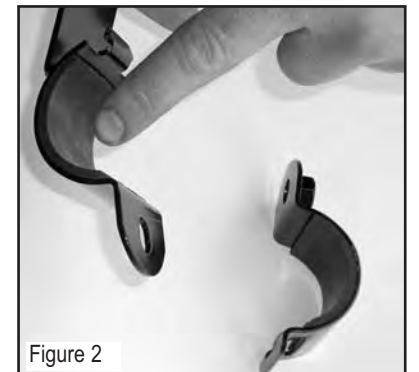



Figure 2

PREPARATION

4. Install rubber bushings (6) around edge of holes in windscreen. **Figure 3.**

 To install the windshield bracket it is necessary to remove the headlight plastic cowl and loosen the support stay. Note the orientation of cowl as you remove this piece in the next step.

5. On left side of motorcycle, remove screw holding plastic cowl piece. **(5mm Hex Key) Figure 4.**

6. Carefully remove plastic cowl.

7. From the underside of the lower triple clamp, remove bolt holding headlight stay. Loosen stay from the underside of the upper triple clamp. Rubber bushing may fall loose. **(12mm Box Wrench) Figure 5.**



Figure 3



Figure 4



Rubber bushing may fall loose when releasing headlight stay.



Figure 5

INSTALLATION

Left Side Mount Bracket

1. Pull forward on headlight and insert the Left Inner Windshield Fork Bracket (2). **Figure 6**

2. Hook the Outer Bracket (8) to the Inner and loosely install one M8 x 20 screw. **(6mm Hex Key) Figure 7 and 8.**

 Adjust clamp to be 60 mm from the top of the lower triple clamp (yoke). Tighten to hold, Do Not firmly tighten at this time.



Figure 6



Figure 7



Figure 8

3. Reinstall head light stay and plastic cowl left and right sides. **Figure 9**

 If necessary, spray the rubber bushing with a small amount of silicone lubricant.
Figure 10



Figure 9



Figure 10

4. Adjust bracket so flat in bracket runs parallel with motorcycle and top edge of bracket is 60mm from top edge of upper triple clamp (yoke). Repeat procedure for right side of motorcycle. **Figure 11**



Figure 11

INSTALL WINDSCREEN

1. Place windscreen onto mounts. Adjust mounts to align to holes in windscreen. Check alignment of windscreen to headlight. Check windshield for symmetry left and right. **Figure 12 and 13**



Take care when installing the 10 x 32 Screws (7) to avoid cross threading.

2. Using one screw (7) and one black cap (5) attach windscreen to mounts. Repeat for all four holes. Tighten screws firmly. **(3mm Hex Key) Figure 14.**



Check all clearances. Turn fork to full left and right stop. Check clearances of mount brackets to motorcycle. Make any necessary adjustments.

3. Tighten the M8 x 20 screws (9) firmly. **(6mm Hex Key) Figure 15**

MAINTENANCE

To clean the screen, wash with a clean soft cloth, plenty of warm water and, if necessary, a non-abrasive soap such as dishwashing liquid. Flannel or soft chamois make good cleaning cloths.



Figure 12



Figure 13

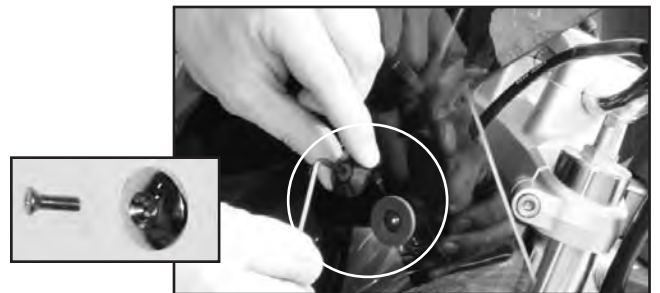

Figure 14



Figure 15

⚠ WARNING

Never ride your motorcycle with loose accessory mounting hardware. Check the hardware for tightness regularly.

Today's motorcycles are built with enough frame rigidity to withstand the moderate loads imposed on them by the foreseeable addition of an accessory(ies). If an accessory(ies) adversely affects your motorcycle's stability, immediately remove the accessory(ies). Do not ride a motorcycle that exhibits unsafe handling traits.

Have experienced service personnel correct any problem before riding with the accessory(ies) installed. For further questions concerning handling problems associated with an accessory(ies), contact your dealer, motorcycle manufacturer, or accessory manufacturer.