

NATIONAL CYCLE, INC. Assembly Instructions and Owner's Manual

Description:	Wiper Kit for N30603 Full Size Windshield	Model:	KYMCO, UXV-700
Part Number:	N30603-WK	Installation Time:	1HR.

Parts List

Item	Part No.	Description	Qty.	Notes and Tools
1	80-875150-000	Motor Assembly	1	Items 1-6 pictured on Page 2
2	80-875152-000	Arm, 12" (30.48cm)	1	Replacement Arm No. N30910
3	80-875154-000	Blade, 14" (35.56cm), Silicone	1	After Installation, Remove Protective Cover Replacement Blade No. N30900
4	44-442523-000	Reservoir and Pump Assembly	1	
5	37-373693-000	Bracket, Tank Hanger	1	
6	80-830326-000	Wire Harness with Switch	1	

BAG#1274

7	80-875156-000	Kit, Spindle Hardware	1	Doga Reference, 100.6469.09.00
8	80-875157-000	Kit, Stud Hardware	1	Doga Reference, 100.6470.09.00
9	44-447167-000	Grommet, Small	1	5/8" (15.24mm) OD
10	44-441927-000	Check Valve	1	
11	44-448726-000	Zip-Tie, 7.5" (19.05cm)	10	Wire Cutter
12	44-448710-000	Zip-Tie, 11 (27.94cm)	2	Wire Cutter
13	49-490543-000	Washer, Flat, SS	2	
14	55-562600-000	Screw, #10-32, SS	2	Flat Blade Screwdriver
15	42-450024-000	Nut, Hex, #10-32, Nylok	2	
16	44-449371-000	Clamp, Wrap Around, 1.50" (3.81cm)	1	
17	44-449380-000	Pin, grommet retaining	1	
18	55-563131-000	Screw, #12 x 1.25" SS	1	Phillips Screwdriver
19	44-447165-000	Grommet, Large	1	3/4" (19.05mm) OD,
20	44-448705-000	Clamp, Cable	1	
21	75-766824-000	Gasket, L= 50" (127cm)	1	

7 x1 Spindle Kit



8 x1 Stud Kit

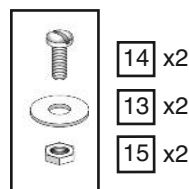
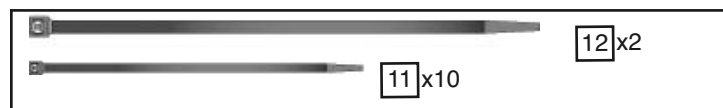
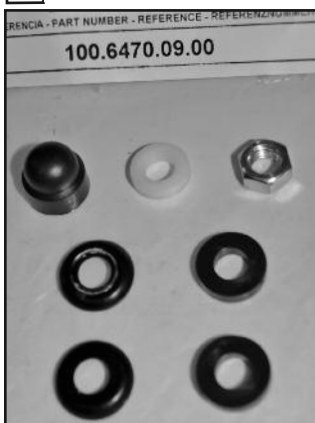

9 x1



10 x1

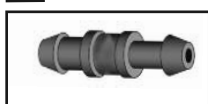

21 x1



PARTS LIST

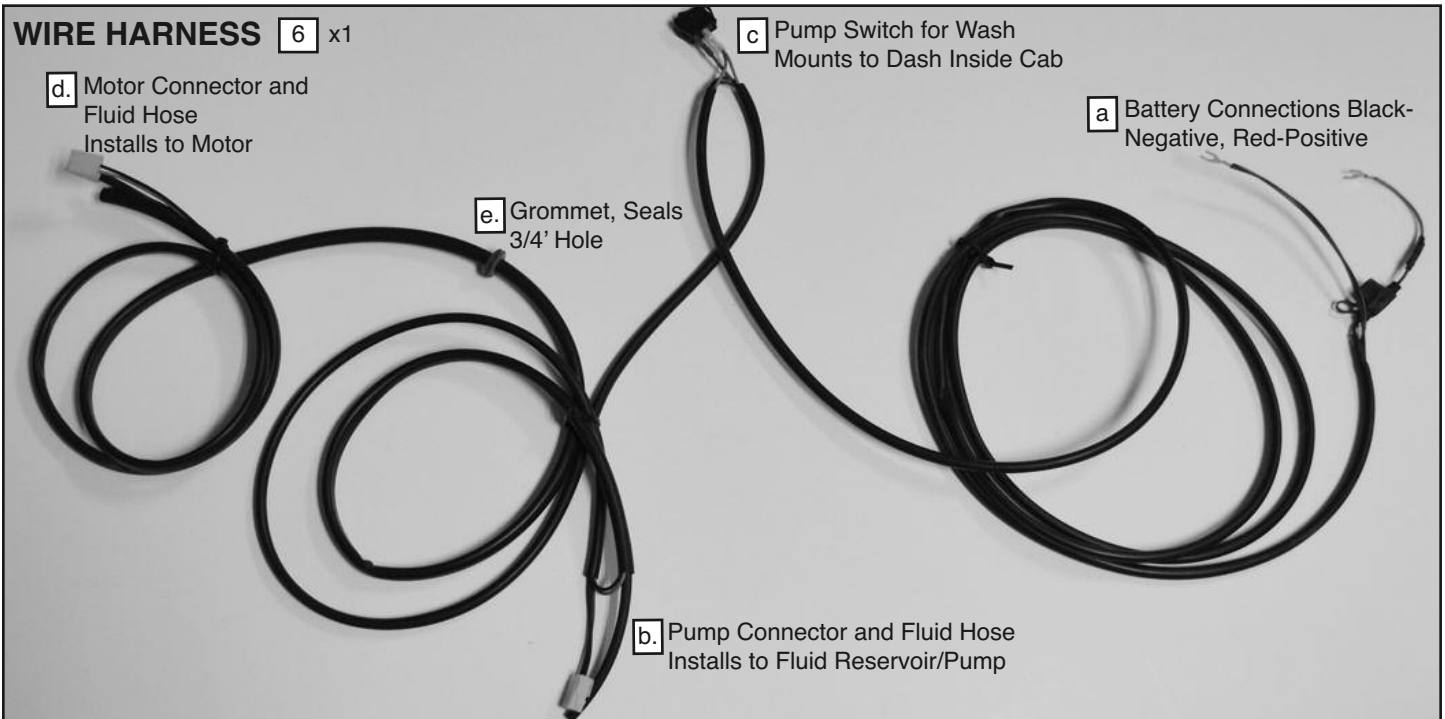
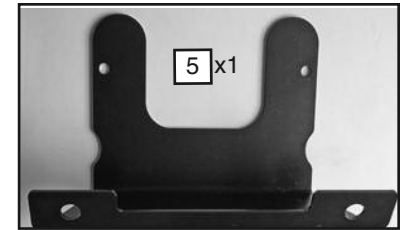
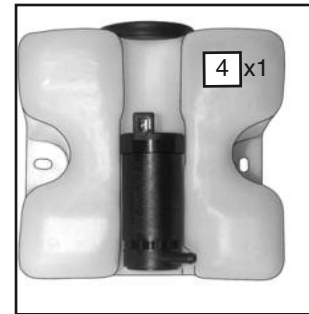
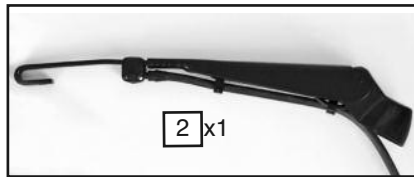
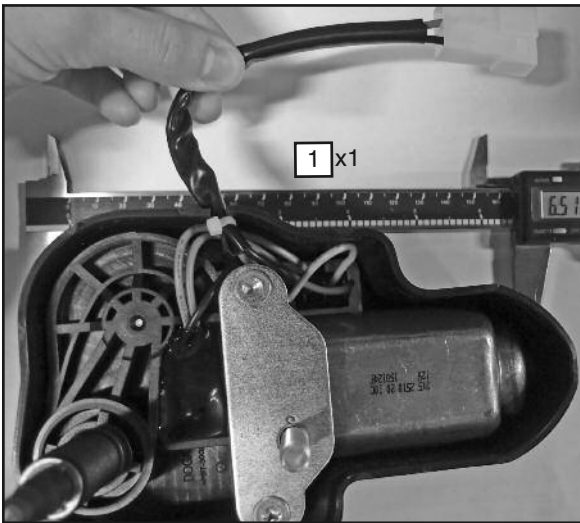

Figure 1

Tool list

- | | |
|------------------------|---|
| 5mm Hex Wrench | Power Drill |
| Flat blade screwdriver | Drill bits, 3/4" and 1/8" |
| Phillips screwdriver | Torque wrench, 3 – 16 ft-lbs [4-22 N-m] |
| X-Acto® knife | Socket and/or wrench set |
| Wire cutters | Marker |

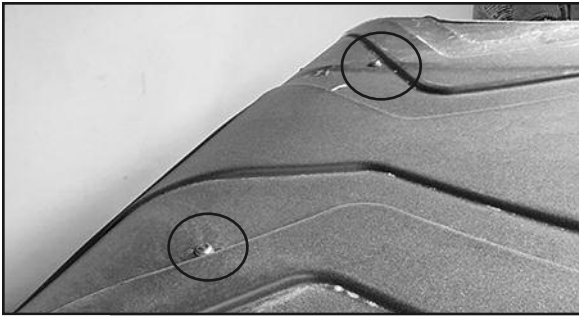
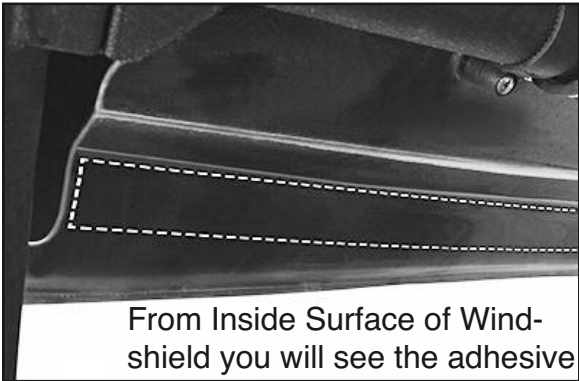

Figure 2



From Inside Surface of Windshield you will see the adhesive

Figure 3



Apply gasket to **Outside Surface** of Windshield!

Figure 4

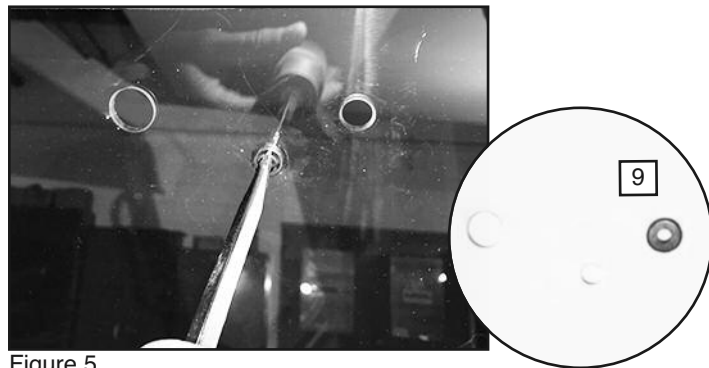



Figure 5

INSTALLATION, Preparation

1. Remove the front hood.

PREPARE THE WINDSHIELD, Install Gasket, Push-out Plugs

 To apply the water seal Gasket (21) to the **Outside Surface** of the Windshield you will need to lift the roof.

1. Remove the two hex screws holding the roof in place. **Figure 2 (5mm Hex Wrench)**
2. Enlist the help of a second person to hold the roof. From the **Outside of the Windshield** install the Foam Gasket as shown. **Figure 3 and 4**
3. From the inside of the windshield, push out the three Plugs in the top center of Windshield. **Figure 5 (Flat Blade Screwdriver)**
4. Install grommet (9) into the hole shown. **Figure 5.**
5. Re-install the two hex screws holding the roof in place. **(5mm Hex Wrench)**

INSTALL WIPER MOTOR, Install Blade to Arm

1. Open the small access cover on the Wiper Blade (3). **Figure 6**
2. Join the end of the Wiper Arm (2) to the Wiper Blade (3). Place the J-hook of the Arm over the Blade's plastic mounting clip until it clicks and locks into place. Close the small access cover. **Figure 6 and 7**

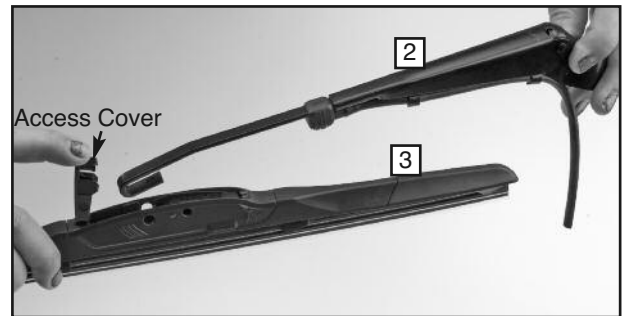

Figure 6



Figure 7

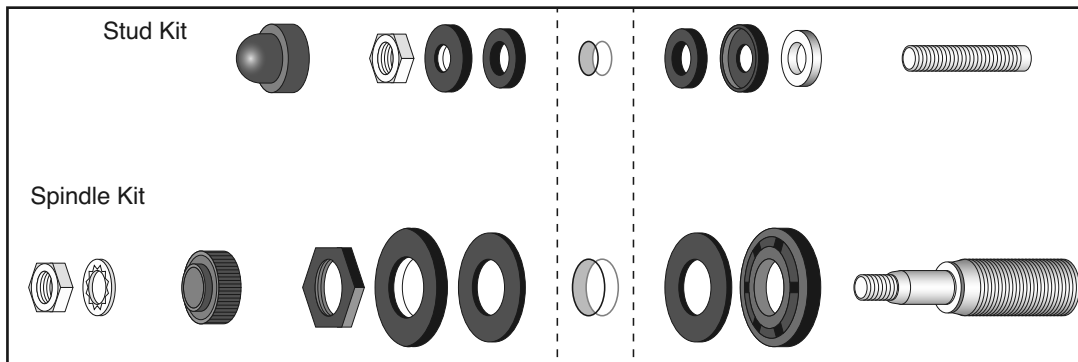

Figure 8

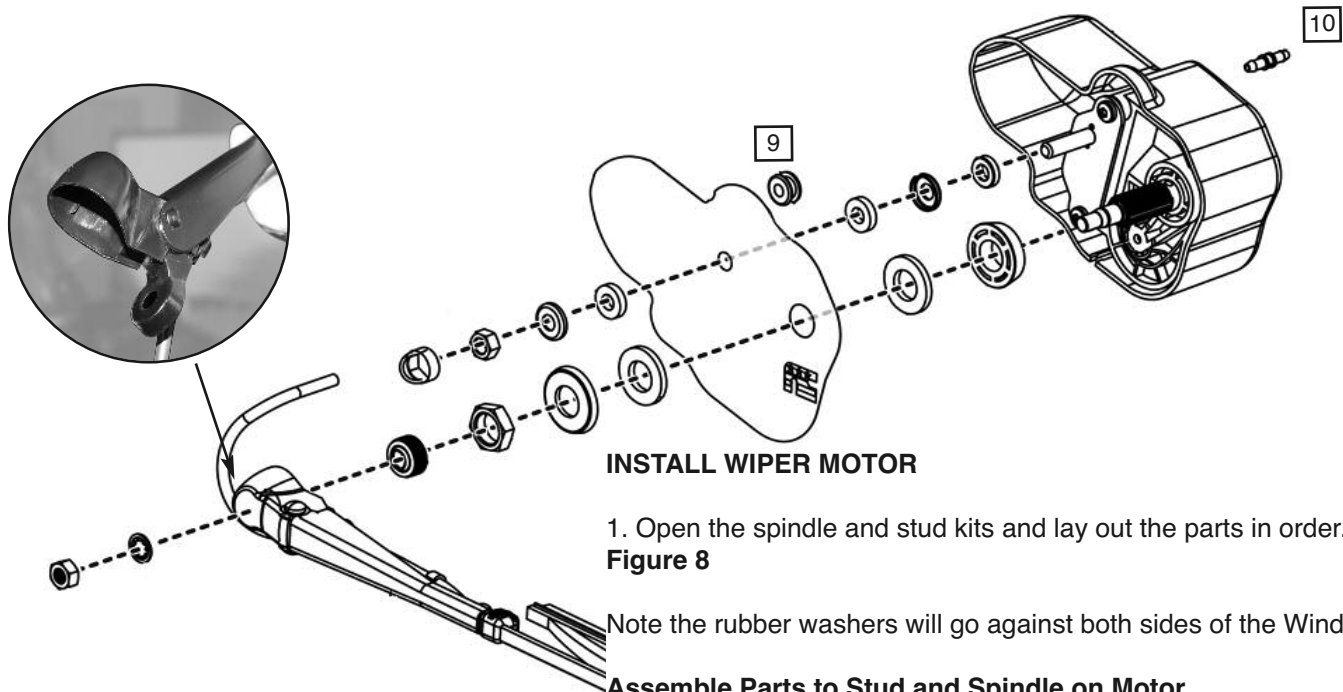

Figure 9

INSTALL WIPER MOTOR

1. Open the spindle and stud kits and lay out the parts in order. **Figure 8**

Note the rubber washers will go against both sides of the Windshield.

Assemble Parts to Stud and Spindle on Motor

2. Assemble the parts that go to the **inside** of the windshield as shown between the motor and the projected motor outline in the **figures 8 and 9**.
3. Hold the wiper motor up inside the cab and insert the wiper motor shafts through the holes in the windshield per the diagram, and assemble the remaining kit hardware located outside of the Windshield. **Figure 8 and 9**
4. The nut on the spindle (larger) shaft needs to be torqued to 4.5 ft-lbs [6 N-m]. **(Torque Wrench)**
5. The nut on the stud (smaller) shaft needs to be torqued to 3 ft-lbs [4 N-m]. **(Torque Wrench)**



Figure 10

WIPER ARM

6. Assemble the wiper arm (so that it is horizontal on the driver's side), then install its lock washer and nut. **Hold the Wiper Arm still while tightening the nut.** Torque to 16 ft-lbs [22 N-m]. **Figure 9 and 10 (Torque Wrench)**

7. Close the cover over the nut.

INSTALLATION, PUMP SWITCH

1. The installation of the Pump Switch on this vehicle is the covered accessory bay provided. Use care when cutting hole, avoid over cutting.

2. Scribe or draw a 17/32" x 1-1/8" vertical rectangular guide directly on the accessory cover.

Figure 11 (Scribe)

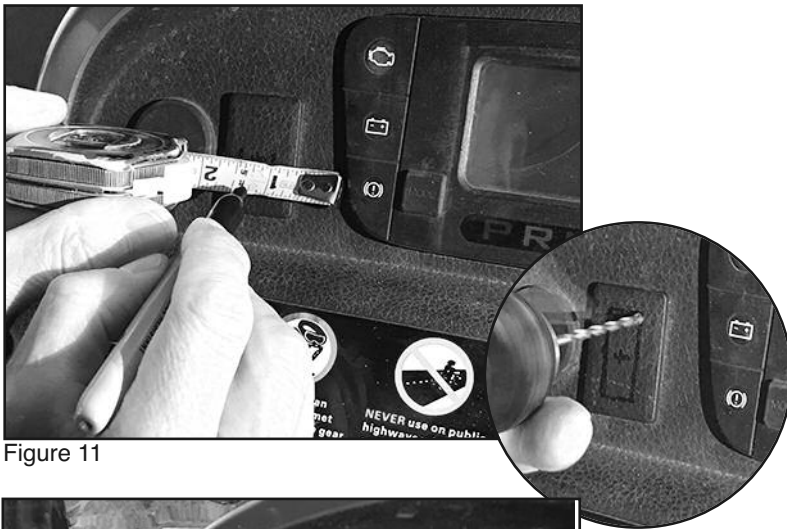

Figure 11

 **Keep Accessory Cover in place when cutting Pump Switch Hole.**

3. Using a 1/8" drill, drill some holes in the plastic cover or dash to serve as starting holes for cutting. Then use your X-acto knife to cut out the opening to the rectangular size. Do Not Over Cut. **Figure 11 and 12 (Drill, 1/8" Drill Bit and X-acto Knife)**



Figure 12

4. Remove the Accessory Cover. **Figure 13 (Small Flat Blade Screwdriver)**



Figure 13

WIRE HARNESS INSTALLATION-ROCKER SWITCH TO DASH

1. Move to the front of the vehicle.

2. Place the Wire Harness inside the front of vehicle.

3. Locate the section of Wire Harness (c) that terminates in the Two-Way Rocker Switch. Temporarily remove the Rocker Switch.

Figure 14, top inset

4. Thread terminus (c), through the fire wall toward the hole you cut in the dash panel's accessory bay in Figure 11 and 12. Thread end (c) through the hole. **Figure 14**

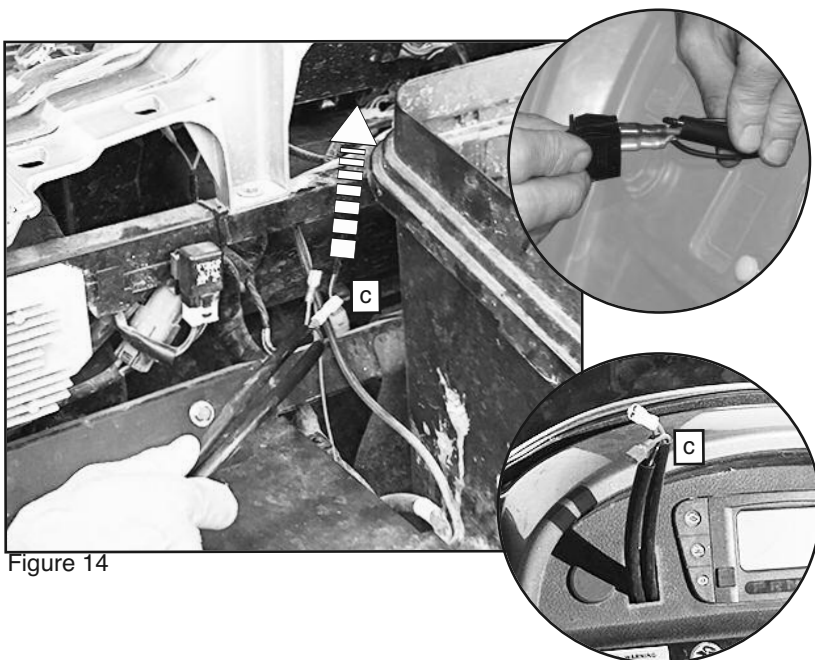

Figure 14



Figure 15

5. Move to the inside the vehicle and insert Rocker Switch through the Accessory Cover from the front.

Figure 15



Figure 16

6. Re-attach the Two-Way Rocker Switch to the two Nylon Pin Connectors (polarity doesn't matter) and then push the Rocker Switch into the cutout. **Figure 16**

7. Completed dash panel Rocker Switch should appear as shown. **Figure 16**

WIRE HARNESS INSTALLATION- CONNECTOR AND FLUID HOSE TO MOTOR

1. Move to the right side (passenger side) of the vehicle. On the right side of the dash, measure a point 1" (25mm) from the top edge of the body and 3/4" (19mm) from the front edge. Mark this location. **Figure 17 (Tape Measure, Marking Pen)**

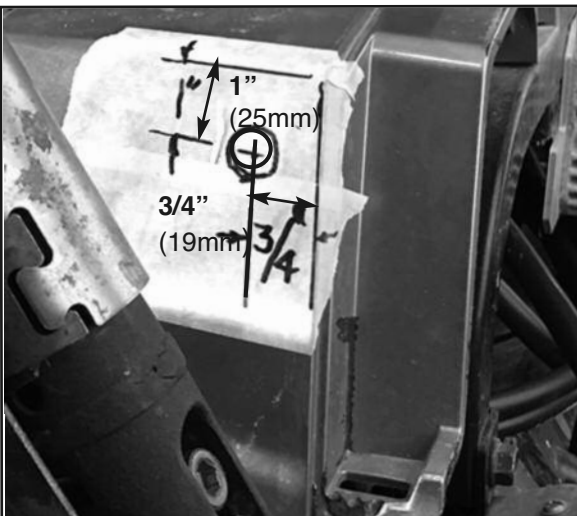

Figure 17

2. Insert a step drill bit (or 3/4 hole saw) into your drill as shown, and drill a 3/4" (19mm) hole in the body cover at the location marked. **Figure 18. (Drill, Step Drill Bit)**

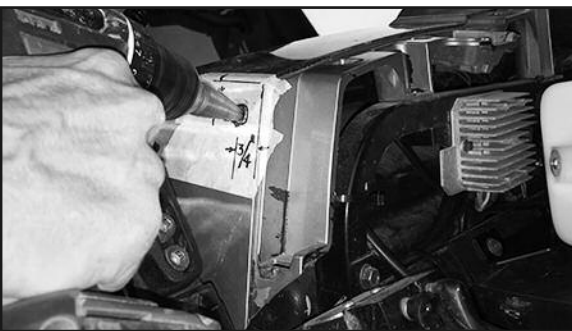

Figure 18

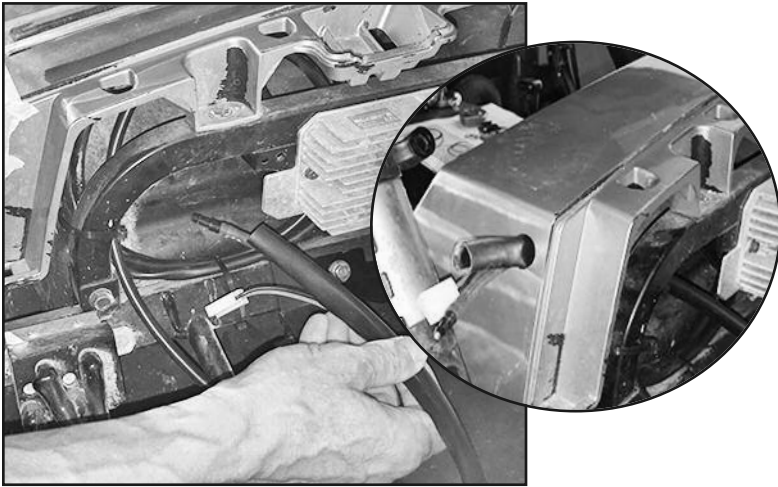

Figure 19

3. From inside the engine compartment, route the (b) end of the harness through the 3/4" (19mm) hole cut into the vehicle's body.
Figure 19

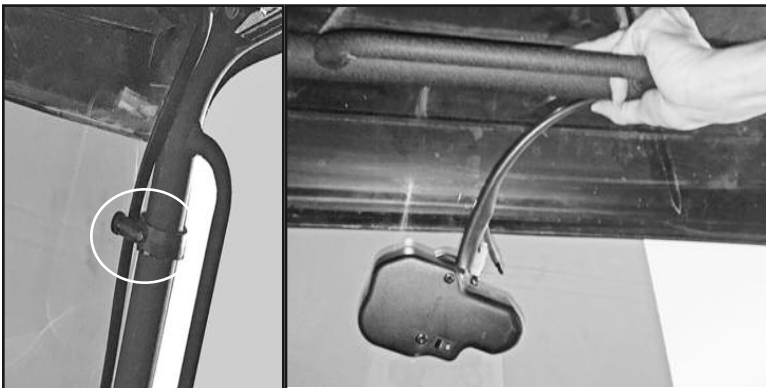

Figure 21

4. Thread the Wire Harness between Clamp and Windshield as you pull the end up toward the Wiper Motor. **Figure 20**

5. Follow the Frame Tube pulling enough length through the 3/4" (19mm) hole so terminus of Motor Connector (d) reaches the Wash'N'Wipe Motor. **Figure 20 and 21**

Figure 20



Figure 22

6. Use the parts shown in figure 22 to support Wire Harness to Top Frame Tube. Do not fully tighten. **(Phillips Screwdriver or Power Drill on low setting)** **Figure 22**

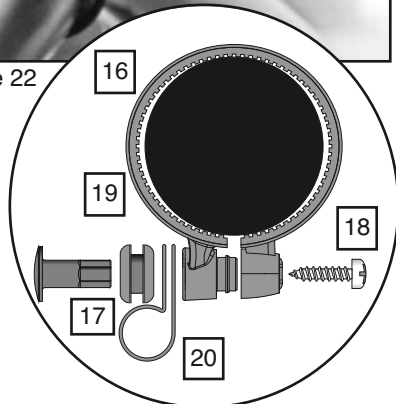

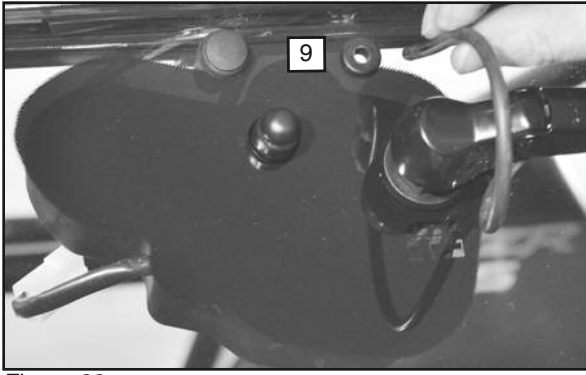

Figure 23

7. Turn motor power switch to the “off” (O) position.

8. Thread the Wiper Arm Fluid Hose through the Grommet (9) in windshield. **Figure 23**

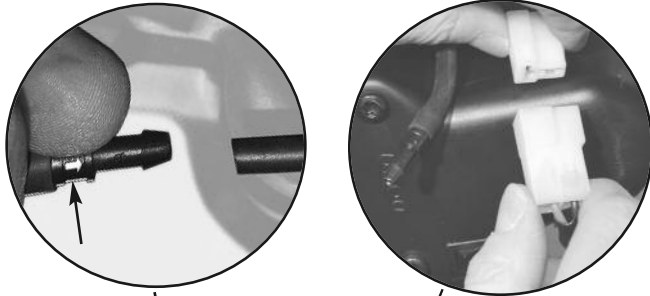



Figure 24

9. Connect the Wiper Motor Power and Fluid Hose. **Figure 24**

 A little moisture on the Fluid Hose end will make them join easier.

10. Tuck Motor Connector behind Motor assembly.

11. Completed Windshield Wiper Motor installation should appear as shown in **Figure 24**.



Figure 25

12. Adjust the slack of the harness across and down the rollbar and tighten the clamps accordingly. **Figure 25**

13. Plug 3/4” hole with grommet attached to Wire Harness. **Figure 25**



Figure 26



Figure 27

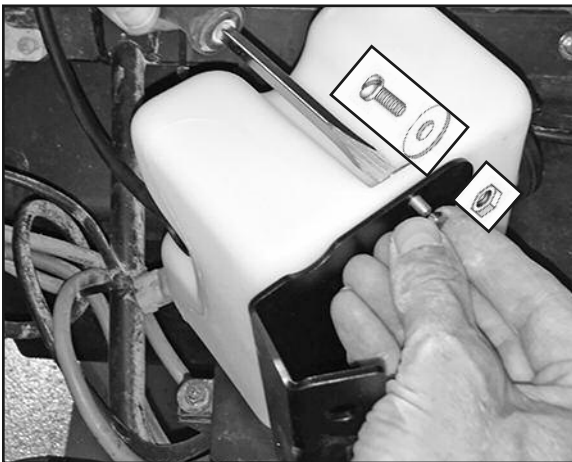

Figure 28



Figure 29

WIRE HARNESS INSTALLATION- BATTERY TERMINUS

1. Remove the cover from the battery box. (Phillips Screw Driver). **Figure 26**

Connect Battery

2. Remove the negative (black) terminal screw and wire connector of the vehicle's battery. Slip the Open Ring Connector under the negative wire connector, replace screw and securely tighten. Repeat for the positive (red) terminal. **Figure 27 (Phillips Screwdriver)**

3. Route the Wire out the side of the Battery Box. **Figure 27**

4. Close battery box cover.

MOUNT RESERVOIR/PUMP ASSEMBLY

1. Attach the reservoir to its bracket using the slotted screws, washers and nuts (14, 13, 15) as shown in Figure 28. Make sure to use the flat washers against the tank flanges. **Figure 28 (Flat Blade Screwdriver)**

2. Attach the Reservoir Bracket (5) to the vehicle's battery box mount on the frame using the stock hardware from the battery box. **Figure 29 (10mm Socket Set)**

 When properly installed there is enough clearance to gain access to the inside of the battery box without removing Reservoir.



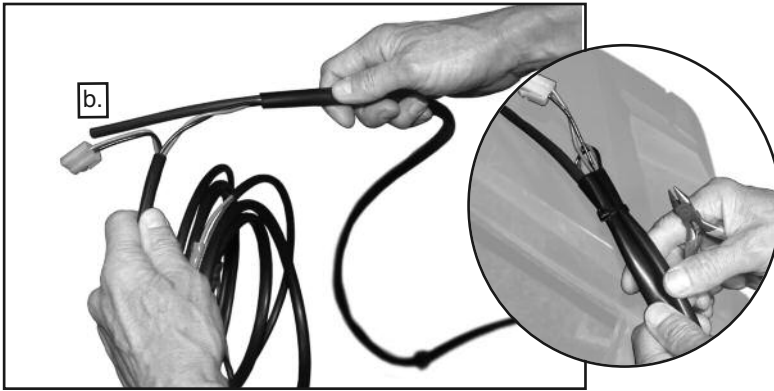

Figure 30

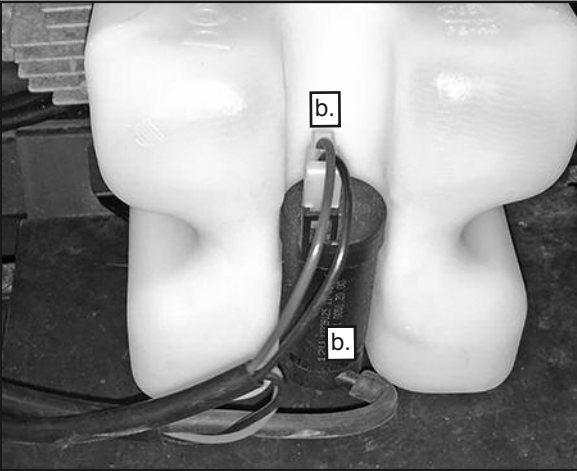

Figure 31

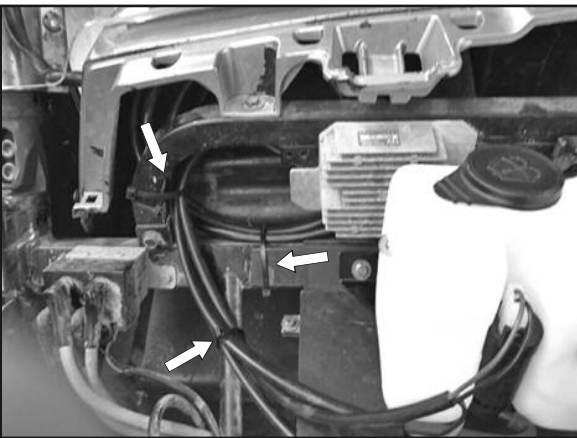

Figure 32

WIRE HARNESS INSTALLATION- PUMP CONNECTOR AND FLUID HOSE

1. Take Pump Quick Connector section (b) of the Wire Harness and locate the terminus of the Rubber Hose and the Large Nylon 2-Pin Electrical Quick-Connector with red and black wires.

Figure 30

2. Take the Quick-Connector section and fold it against the Rubber Hose section. Secure the two sheaths with a Zip-Tie (11) and trim the excess. **Figure 30 (Wire Cutters)**

3. Connect the Rubber Hose to the bottom of the Reservoir's Electrical Pump.

Figure 31

4. Push the Nylon Quick-Connector onto the two pins on top of the Reservoir's Electrical Pump.

Figure 31

SECURE WIRE HARNESS

1. Use Zip-Ties (11 and 12) to secure harness to places indicated in figure 32. **Figure 32 (Wire Cutters)**



Do not leave loose Harness anywhere in the vehicle. Once Zip-Tie is tight, clip excess off end. (Wire Cutters)

TIGHTEN HARDWARE

1. Tighten the center clamp supporting the Wire Harness.

2. Check all hardware for tightness regularly.

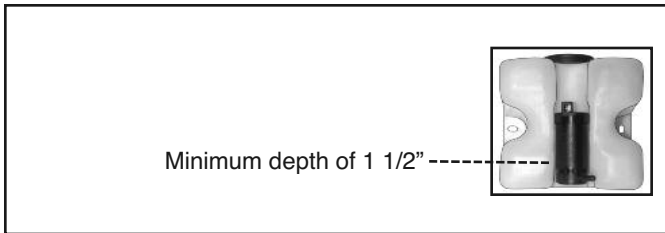

Figure 33



Figure 34

FILL THE FLUID RESERVOIR

1. Fill the Reservoir (9) inside the vehicle's cab with plain water during warm weather and glycol-based automotive windshield washer fluid in freezing weather.



DO NOT run the pump dry. Minimum amount of fluid to maintain in the Reservoir is 12 oz. (.35L) or to a depth of 1 1/2" (38mm) **Figure 33**

WINDSHIELD WIPER OPERATION

1. Remove the Blade Cover before operating the Wiper. Figure 34



The Wiper is intended for use with the wash cycle or during rain. **DO NOT** wipe a dry windshield.

2. The dash panel Rocker Switch installed controls the fluid spray. Momentarily hold the Switch in the on position to spray water from the Wiper Arm. It should spray in four separate directions.



The 4 spray jets can be redirected carefully.

3. The Wiper Motor has an on/off Rocker Switch. Turn the switch on and verify that the Wiper works as expected.

Enjoy Your New Wash'n'Wipe™ Windshield!

CLEANING AND MAINTENANCE

To clean the screen, wash with a clean soft cloth, plenty of warm water and if necessary, a non-abrasive soap such as dishwashing liquid. Flannel or soft chamois make good cleaning cloths. **Paint, glue residue or grease removal:** Moisten cotton with naphtha or turpentine followed by a wash as above.

Do not clean polycarbonate in hot sun or high temperatures. Do not clean the screen with glass cleaners.

Do not allow brake fluid, alcohol, or strong solvents to contact the screen.

WARNING

Never operate your vehicle with loose accessory mounting hardware. Check the hardware for tightness regularly.

UTVs are built with enough frame rigidity to withstand the moderate loads imposed on them by the foreseeable addition of an accessory(ies). If an accessory(ies) adversely affects your vehicle's stability, immediately remove the accessory(ies). Do not operate a vehicle that exhibits unsafe handling traits.

Have experienced service personnel correct any problem before driving with the accessory(ies) installed. For further questions concerning handling problems associated with an accessory(ies), contact your dealer, UTV manufacturer, or accessory manufacturer.

CAUTION: Do not clean polycarbonate in hot sun or high temperatures. Do not clean the screen with glass cleaners. Certain chemicals, generally known as acidic hydrocarbons, are known to cause polycarbonate damage. Do not allow brake fluid, alcohol, or strong solvents to contact the screen.

CAUTION: Do not use rain protective products made for glass. We recommend National Cycle's **RainZip®** (N1410-01) to help shed water in rainy weather.

CAUTION: Always face windshield forward (in direction of travel) while carrying on truck or trailer.

CAUTION: Do Not Wipe a dry Windshield, Wash, then Wipe. Remove protective cover from Wiper Blade before use.