

PARTS LIST

Description	Qty.
Light bar Assembly, N945	1
Connectors, Scotchlok	6
M6 x 16 Screw	2
Washer, Flat	2



Small, Thin Flat Blade Screwdriver to remove caps on headlight shell.
Screwdriver, #2 Phillips
8mm Socket, Handle and 3" Extension
Hex Key 5mm
Pliers, Slip Joint and Scissors

PREPARATION

1. Make certain the motorcycle is securely positioned for this installation. Cover the front fender with a protective cloth to avoid scratches.
2. Remove caps that cover the headlight screws. Remove headlight screws. (**Small Screwdriver and #2 Phillips Screwdriver**) **Figure 1 and 2.**
3. Disconnect headlight at two places. Set light aside. **Figure 3.**
4. Disconnect the **Right (Orange)** and **Left (Blue)** turn signal connectors.
5. Remove the Screws with the 8mm hex head that hold the turn signal bar to the under side of triple clamp. Remove turn signal bar. Bar and screws will not be re-used. (**8mm Socket**) **Figure 4.**

NOTE: right and left on the motorcycle are determined from the rider's position.

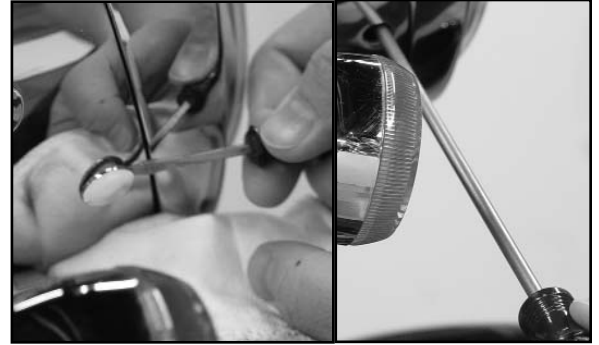

Figure 1

Figure 2

INSTALLATION

NOTE: An assistant to hold light bar will be helpful in step 6.

6. Mount the Light Bar Assembly. Hold Light Bar in place at underside of triple clamp. Use the M6 x 16 Screws with a Flat Washer to install the Light Bar assembly. Tighten Firmly. (**5mm Hex Key**) **Figure 5.**
7. Route the Light Bar Wires to the back and into headlight shell.

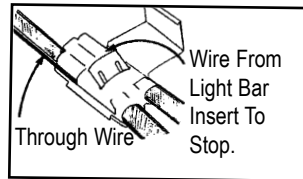

Figure 3

WIRE LIGHT BAR

HELPFUL WIRE TIPS: **A.** Keep the Right and Left Wires of the Light Bar in separate groups. **B.** Inside the headlight shell, the wires bundled in the Blue Connectors are for Right side operation and Orange Connector is Left. **C.** You will need to remove 2-3" of electrical tape from the Blue/Yellow Stripe, Low Beam Wire inside the headlight to have room for two Scotchlok Connectors going to this wire. (**Scissors**) **Figure 6.**

8. Attach wires as recommended in the following list. Do one at a time and check for correct operation. (Connectors and Pliers).



LIGHT BAR MAIN SPOT

MOTORCYCLE

Left and Right SHORT BLACK to Blue /Yellow Stripe, Low Beam

LIGHT BAR TURN SIGNAL

Right LONG RED to Grey Wire (in Blue Bundle)
Left LONG RED to Green Wire (in Orange Bundle)

LIGHT BAR RUNNING LIGHTS

Right LONG BLACK to Red w/Blue Stripe (in Blue Bundle)
Left LONG BLACK to Red w/ Blue Stripe (in Orange Bundle)

9. Test lights. Re-install headlight and rim.



Figure 4

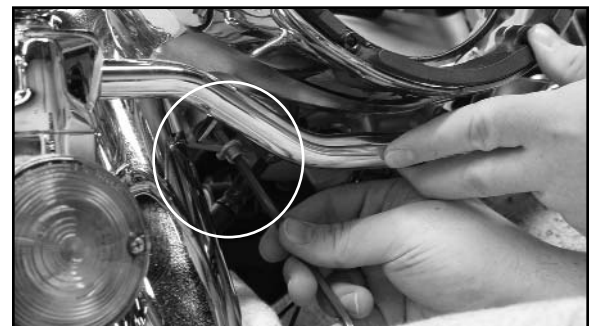

Figure 5



Figure 6

! WARNING

After wiring the light bar check for clearance. Make sure the wires can not get pinched when the fork is turned to a full fork lock left and right.

Check all lights for proper operation.

Check the tightness of all fasteners that have been involved in this installation.

MAINTENANCE

The high quality chrome finish of your National Cycle light bar can be maintained with any quality chrome cleaner and /or polish.

REPLACEMENT PARTS and ACCESSORIES

Order parts through your local dealer or contact National Cycle.

Description	Part No.
Light Head Assembly	90-910570-000
Lamp Assembly E13/DOT Reflector, Lens and Bulb	90-901012-000
Turn Signal Assembly	90-930921-000
Turn Signal Lens	90-930213-000

Turn Signal Bulb Only: Bulb 1157 Available at Most Auto Parts Stores.

Light Bar Accessories

Chrome Visor	N9005
Alternate Thumb Switch	N9001

ADJUSTMENT

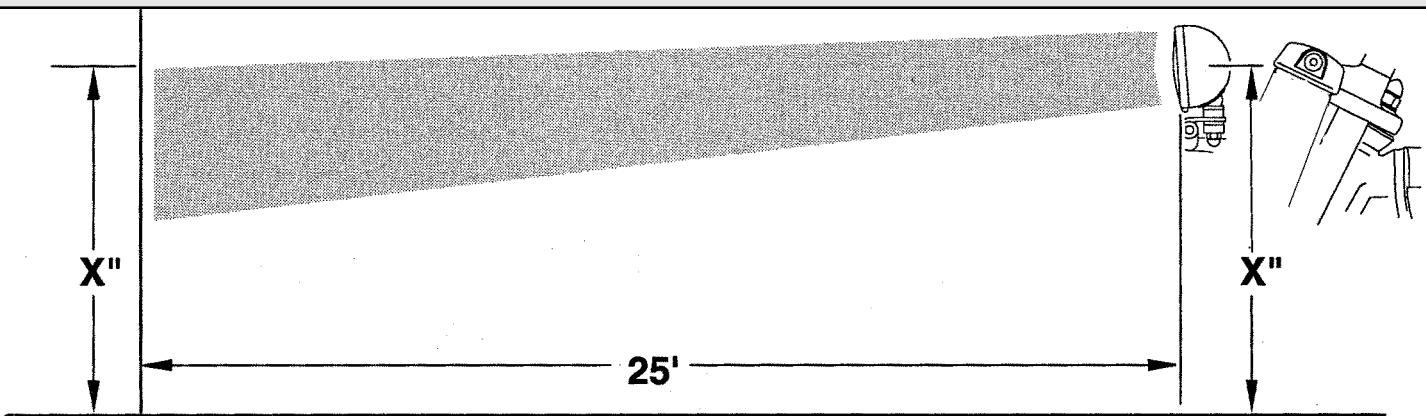

NOTE: check vertical aim of the lamps. They should aim approximately 5° downward. If adjustment is required see "Adjustment" page 2 of this instruction otherwise proceed with wiring step 2.

1. HORIZONTAL AIM

A. To adjust the Spotlights or Turn signals right or left gently rotate the lamp into the correct position. In the event that the lamps become loose, refer to the procedure for vertical adjustment.

2. VERTICAL AIM

A. Loosen the nut on the Spotlight stud, adjust the Spotlights by rotating into position, tighten firmly. (**11/16" Wrench**)



To adjust vertical aim you will need these additional tools: 11/16" Open Ended Wrench

Installing optional N9005 Light Head Visor.

1. Loosen the rim of the light head assembly. (Phillips Screw Driver).
2. Slip tabs of Visor under rim. Item E.
3. Shape Visor / Visor Tabs to conform to contours of light head assembly.
4. Retighten rim.

