



VStream+<sup>+</sup>

VStream® Windscreen Patent No. 7,387,328



**INSTALLATION INSTRUCTIONS**  
VStream+® Windcreens for Yamaha® MT-10

N20346 VStream+, Dark Tint  
N20347 VStream+, Light Tint  
N20348 VStream+, Clear

Scan QR Code to watch the installation video.



Thank you for purchasing a National Cycle product. Read these instructions carefully and thoroughly before beginning work. Dealers, if installing this windshield for a customer, please give them this manual upon completion. It contains information needed to properly maintain and use this product.

Description:	VStream+® Replacement Windscreen	Model:	2022-Current Yamaha® MT-10
Part Number:	N20436/N20437/N20438	Installation Time:	15 min. Difficulty Level: Easy



**ATTENTION:** Special notes and cautionary measures which can prevent damage to the accessory or vehicle.



**NOTE:** Tips for facilitation of operation, control and adjustment, as well as maintenance work.

**PACKAGE CONTENTS**

ITEM	PART NO.	DESCRIPTION	QTY.
A		Windscreen; 4.5--mm Polycarbonate	1
B	37-374664-000	VStream+ Mounting Bracket, Black	1
<b>BAG#1418</b>			
C	49-490520-000	1/4" Washer, Zinc, Black	3

**ALL OEM FASTENERS WILL BE REUSED.**

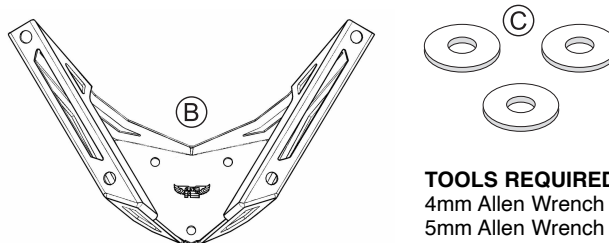

**TOOLS REQUIRED**  
4mm Allen Wrench  
5mm Allen Wrench



Step 01

**PREPARATION**

**Step 01**

With a 4mm Allen Wrench, remove the four OEM bolts securing the OEM windscreen to the bike. Save these for later reinstallation.

**Step 02**

Under the OEM windscreen is a rubber air dam. Remove this component. It will not be reused.

**Step 03**

The OEM windscreen bracket is secured by three mounting bolts. Use a 5mm Allen Wrench to remove them. The bracket will not be reused, but the three bolts will be reinstalled later.



Step 02



Step 03



Step 04

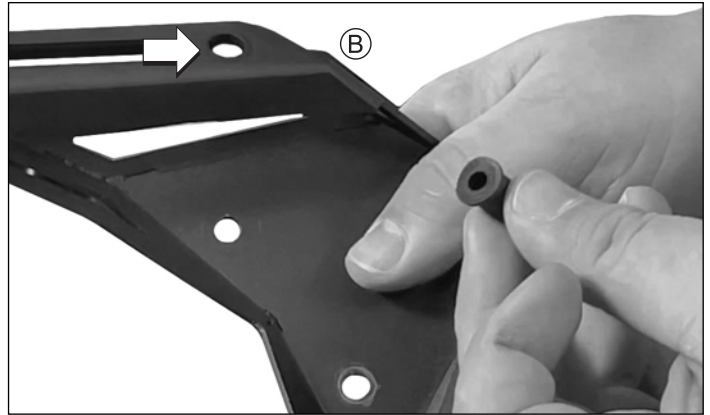

Step 05

**PREPARATION, CONT'D.**

**Step 04**

Remove the four rubber Wellnuts from the OEM bracket.



*If this is not the first time the OEM windscreen and/or windscreen bracket has been removed, inspect the health of the Wellnuts. The rubber should be firm and tight around the threaded brass inserts.*

**INSTALLATION**

**Step 05**

Insert these four rubber Wellnuts into the four outer mount holes of the VStream+ Mounting Bracket (B).

**Step 06**

Your Kit includes three 1/4" Washers (C). Install these on the three OEM mounting bolts removed in Step 03.

Position the VStream+ Mounting Bracket (B) onto the rubber Wellnuts in the mount points on the bike, and secure with the OEM bolts and new Washers.



*As with all Wellnuts, do not push too hard on the mounting bolts until you are certain the threads have engaged. Be careful not to push them inside of the cowling/gauge assembly.*

Use a 5mm Allen Wrench to securely tighten the mounting bolts. Be careful not to over-torque them.

**Step 07**

Check all bolts for tightness, and make sure the Wellnuts are in place as shown.

**Step 08**

Use the four OEM windscreen mounting bolts that were removed in Step 01 to install your new VStream+ Windscreen (A).

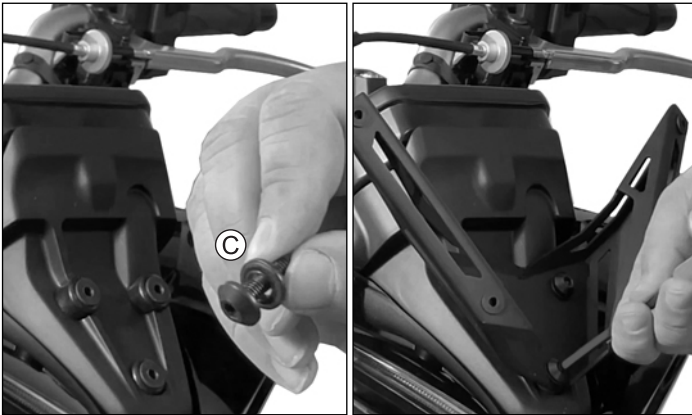

Step 06

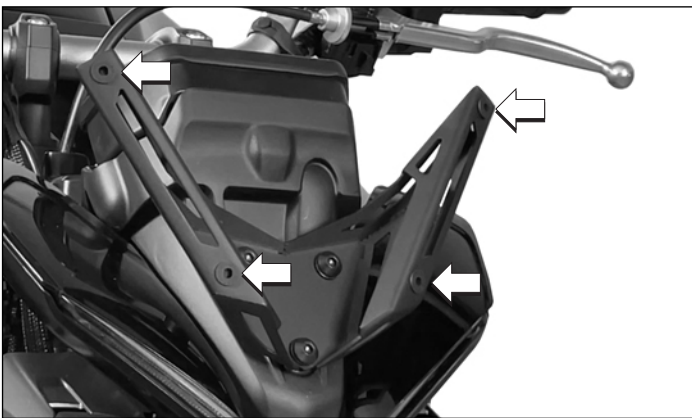

Step 07



Step 08



Step 09

## INSTALLATION; CONT'D.

### Setp 09

Use a 4mm Allen Wrench to tighten all four windscreen mounting bolts securely.

Your VStream+ installation is complete.

***Now go out and enjoy the ride!***



## CLEANING AND MAINTENANCE

To clean the screen, wash with a clean soft cloth and plenty of warm water and, if necessary, a non-abrasive soap such as dishwashing liquid. Flannel or soft chamois make good cleaning cloths. Paint, glue residue or grease removal: Moisten cotton wad with naphtha or turpentine followed by a wash as above.

National Cycle **Shield Wash™** (N1401-01) makes a good daily cleaner and comes with a handy travel-size bottle. Shield Wash is safe for all windshields and helmet visors

Do not clean polycarbonate in hot sun or high temperatures. Do not clean the screen with household glass cleaners. Do not allow brake fluid, alcohol, or strong solvents to contact the screen.

### RAIN REPELLENT

Do not use rain protective products made for automotive glass. We recommend National Cycle's **RainZip®** (N1410-01) to keep your windscreen clear in rainy weather.



Register Your Windshield Online at [www.nationalcycle.com](http://www.nationalcycle.com)

### National Cycle 3-Year Limited Warranty

National Cycle hereby warrants to the original registered owner of a National Cycle polycarbonate windshield for a period of three years from the date of purchase against breakage. This limited warranty is expressly limited to the replacement of the polycarbonate windshield. This limited warranty does not include scratches, coating failure, cosmetic wear and tear, replacement of hardware, or any consequential damages or expenses including labor cost of installation, removal and/or replacement, inconvenience, inbound freight expenses or damage to any other component of the motorcycle or any other accessories. Certain chemicals, generally known as acidic hydrocarbons, are known to cause polycarbonate damage and will not be covered under this limited warranty. Please refer to the cleaning instructions supplied with all National Cycle windshields.

Visit [www.nationalcycle.com](http://www.nationalcycle.com) for further details, or call or write National Cycle

## ⚠ WARNING

Never ride your motorcycle with loose accessory mounting hardware. Check the hardware for tightness regularly.

Today's motorcycles are built with enough frame rigidity to withstand the moderate loads imposed on them by the foreseeable addition of an accessory(ies). If an accessory(ies) adversely affects your motorcycle's stability, immediately remove the accessory(ies). Do not ride a motorcycle that exhibits unsafe handling traits.

Have experienced service personnel correct any problem before riding with the accessory(ies) installed. For further questions concerning handling problems associated with an accessory(ies), contact your dealer, motorcycle manufacturer, or accessory manufacturer.

**Sunlight reflected off the inside curvature of the windscreen can, at certain times of day, cause extreme heat buildup on the motorcycles instruments and possibly even melt them. Exercise care in parking to avoid this. Park your motorcycle facing the sun or place an opaque object over this area.**