



<p>Attention</p>  <p>Special notes and cautionary measures which can prevent damage to the accessory or motorcycle.</p>	<p>Note:</p>  <p>Tips for facilitation of operation, control and adjustment, as well as maintenance work.</p>
---	---

Check contents of this package against parts list. Report any missing parts to your dealer or ZTechnik directly. The following information is necessary: Bag Number and Date Stamp(s) on outside of Kit or Box and Place of Purchase.

Kit-Z2405 and Z2408 Parts List				
Index	Part Number	Description	Qty.	Notes
1		Windshield, Hardcoated Lexan® polycarbonate	1	With US or European Turn Signal Cutout
2	37-370724-000	Bracket, Main	1	
3	37-370727-000	Face Plate	2	
Bag# 861				
4	55-563220-000	Torx Screw M6 x 20	6	
5	42-483006-000	Nut, Cap	6	
6	51-516445-000	Hex Screw M8 x 45	2	
7	51-515321-000	Hex Screw, M6 x 20	2	
8	43-433032-000	Nut, Whizlok M8-1.25	2	
9	75-765010-000	Gasket, Left	2	With Adhesive
10	75-765011-000	Gasket, Right	2	With Adhesive
11	49-495555-000	Collar, L .177"	6	
12	49-491112-000	Washer, Split M6	2	
13	49-490511-000	Washer, Flat M6	2	



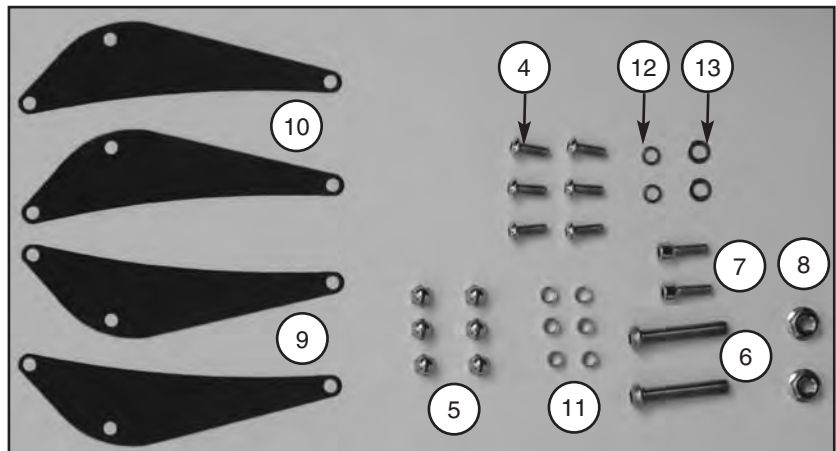
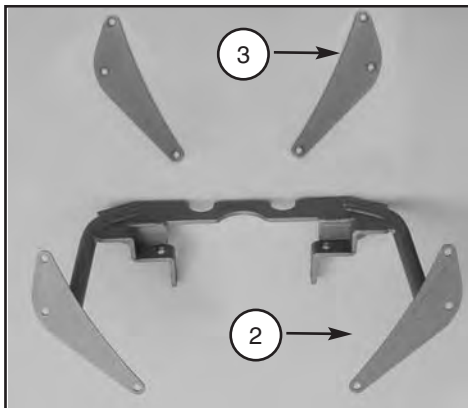

- TOOLS REQUIRED:**
- T45 Wrench
 - 13mm Combination Wrench
 - Allen Wrench, 5mm
 - T30 Wrench
 - Box End Wrench, 10mm

PREPARATION

The ZTechnik main bracket design is a strong mount developed using steel. Welded construction provides four mounting points for high-strength fasteners creating a torsionally rigid mounting platform for the Z2405 and Z2408 VStream windshield that does not interfere with the look of the motorcycle.

 Care must be taken when installing the main bracket. Cover the plastic trim piece and upper triple clamp area with a low tack adhesive tape such as masking tape to prevent scratching the motorcycle's finish!

 A second person will be required in installation to support the handlebar assembly while you place the bracket!

 Right and left side of motorcycle is determined while sitting on the bike.

INSTALLATION OF MAIN BRACKET

1. Remove the stock handlebars from the clamps. (T45 Torx) **Figure 1**

2. Have someone straddle the front wheel and hold bars up and forward to allow clearance for the arms of the bracket to go under cables. **Figure 2**

3. From the rider's position on motorcycle work the left arm of the main bracket *under* the bar and cables and the right arm *over* the throttle cable and under the bar and brake cable(s). Take care not to scratch the motorcycle's finish. **Figures 3 and 4**

4. Seat main bracket on top of triple clamp. **Figure 4**
Rest handlebars into position. **Do not secure.**



Figure 1



Figure 2

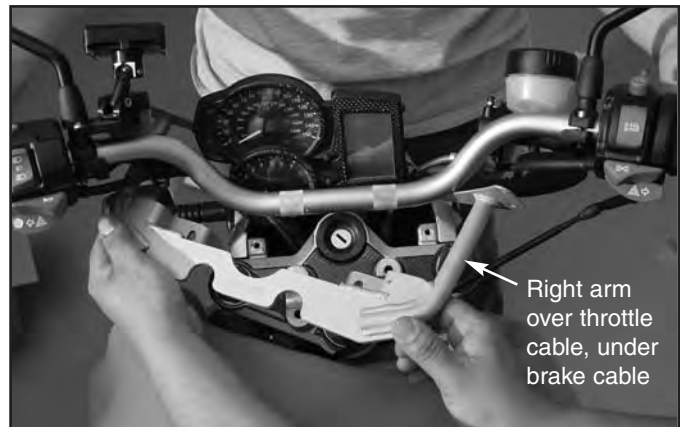

Figure 3

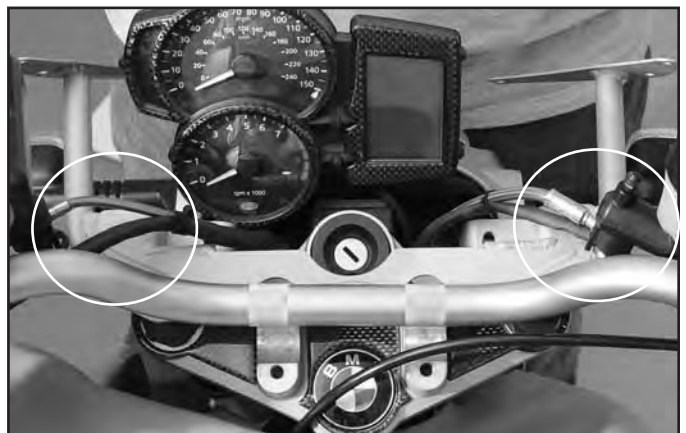

Figure 4

5. From the outside of the motorcycle, install the two M8 x 45 screws (6) and nuts (8). **Do not fully tighten. (5mm Allen Wrench and 13mm Combination Wrench) Figure 5**

6. Assemble a lock washer (12) and a flat washer (13) on a M6 x 20 screw (7). Align bracket and install screw assemblies into top hole. **Do not fully tighten. (5mm Allen Wrench) Figure 6**

7. Re-install handlebars and fully tighten to torque specification in motorcycle owner's manual. **(T45 Torx)**

8. Fully tighten all fasteners on main bracket. **(5mm Allen Wrench, 13mm Combination Wrench and 10mm Wrench)**

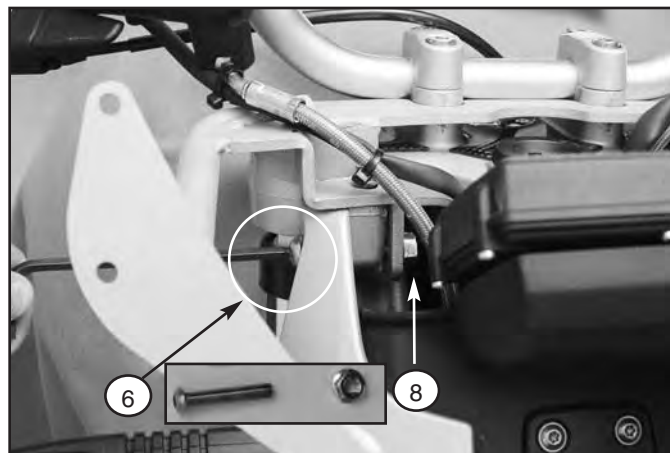

Figure 5

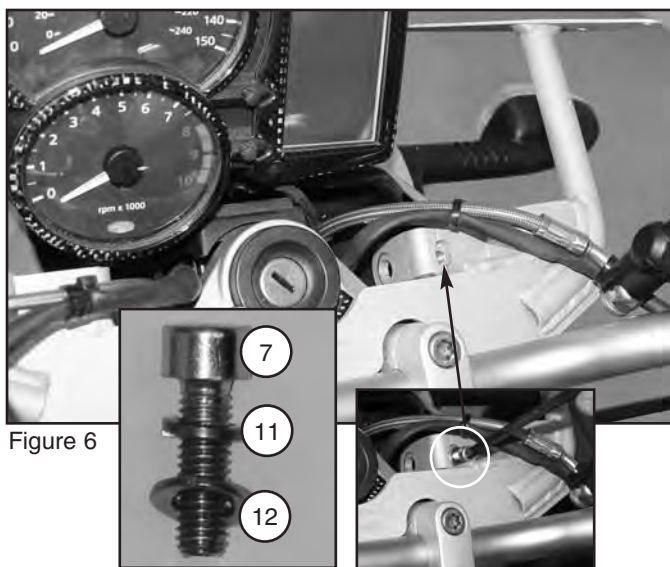

Figure 6

INSTALLATION OF WINDSCREEN

9. Remove paper backing from a gasket. Apply right and left gaskets to the arms of the main bracket and to the inside of each front plate. **Figure 7**

Assemble windscreen to mount arms.

A spring clamp or someone to hold windscreen in place while assembling face plates will be helpful. **(Spring Clamp) Figure 8**

10. Hold windshield in position at arms of main bracket.

11. Insert a collar (10) into the top hole. Attach face plate assembly to the front with a screw (4) and secure from the back with a cap nut (5). Repeat for other holes. **(T30 Torx and 10mm Wrench) Figure 9**

12. Tighten all hardware firmly.

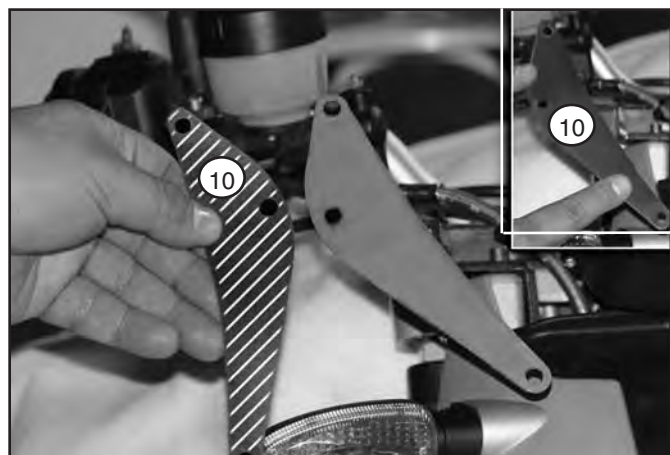

Figure 7

MAINTENANCE

To clean the screen, wash with a clean soft cloth, plenty of warm water and if necessary, a non-abrasive soap such as dishwashing liquid. Flannel or soft chamois make good cleaning cloths. **Paint, glue residue or grease removal:** Moisten cotton with Naphtha or Turpentine followed by a wash as above. National Cycle Shield Wash™ makes a good daily cleaner and comes with a handy travel size bottle. N1401 Shield Wash is safe for helmet visors.

Do not clean polycarbonate in hot sun or high temperatures. Do not clean the screen with glass cleaners. Do not use rain protective products on the screen other than National Cycle brand Rain Zip®, Part No. N1410-01. Do not allow brake fluid, alcohol, or strong solvents to contact the screen.



Figure 8

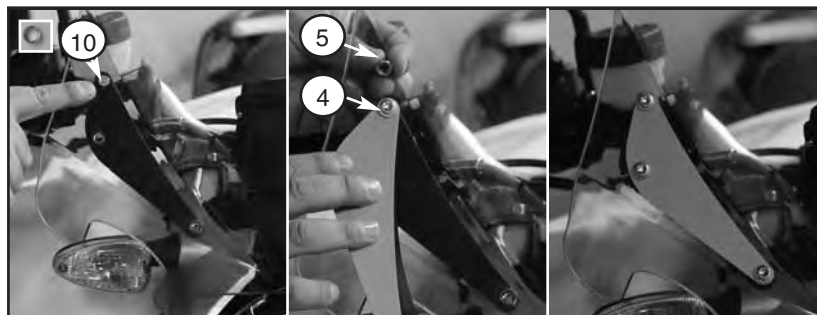

Figure 9

⚠ WARNING

Never ride your motorcycle with loose accessory mounting hardware. Check the hardware for tightness regularly.

Today's motorcycles are built with enough frame rigidity to withstand the moderate loads imposed on them by the foreseeable addition of an accessory(ies). If an accessory(ies) adversely affects your motorcycle's stability, immediately remove the accessory(ies). Do not ride a motorcycle that exhibits unsafe handling traits.

Have experienced service personnel correct any problem before riding with the accessory(ies) installed. For further questions concerning handling problems associated with an accessory(ies), contact your dealer, motorcycle manufacturer, or accessory manufacturer.

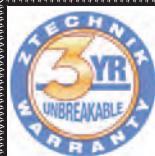

ZTechnik 3-Year Limited Warranty

Register your windshield on Line at: www.ZTechnik.com

ZTechnik hereby warrants to the original registered owner of a ZTechnik polycarbonate windshield for a period of three years from the date of purchase against breakage. This limited warranty is expressly limited to the replacement of the polycarbonate windscreen. This limited warranty does not include scratches, coating failure, cosmetic wear and tear, replacement of hardware, or any consequential damages or expenses including labor cost of installation, removal and/or replacement, inconvenience, inbound freight expenses or damage to any other component of the motorcycle or any other accessories. Certain chemicals, generally known as acidic hydrocarbons, are known to cause polycarbonate damage and will not be covered under this limited warranty. Please refer to the cleaning instructions supplied with all ZTechnik windshields.

Visit www.ZTechnik.com for further details or call or write ZTechnik / PO Box 158 / Maywood, IL 60153 / 708-3430400

ZTechnik PO Box Maywood, IL 60153-0158 USA

708-343-0400 / Fax: 708-343-0625 / www.ZTechnik.com / e mail: info@ZTechnik.com

©2007 National Cycle, Inc.

Page 4 of 4

10-119741-000 07/07 Rev. B 10/10