

Thank you for purchasing a National Cycle Accessory. Before beginning installation please look over this guide and be sure one possess the skills and workshop tools to properly complete the installation. Otherwise a motorcycle dealer would be glad to complete the installation.

**Dealers:** If installing the windshield for a customer please give them this manual. It contains information needed to properly maintain and use this product.

**Attention:**



Special notes and cautionary measures which can prevent damage to the accessory or motorcycle.

**Note:**



Tips for facilitation of operation, control and adjustment, as well as maintenance work.

- TOOLS**
- 8mm Box Wrench
  - 3mm Hex Key
  - 5mm Hex Key
  - 4mm Hex Key
  - Anti Seize or similar product.



Left and Right side of motorcycle is determined while sitting on the bike.

**PARTS LIST**

INDEX	PART NO.	DESCRIPTION	QTY.
1		Hardcoated Polycarbonate VStream Windscreen	1
2	37-370680-000	Bracket, Left Side	1
3	37-370681-000	Bracket, Right Side	1

**BAG#1075**

4	51-514212-000	Screw, M6 x 12, Stainless Steel	6
5	44-447304-000	Grommet, Black	6
6	34-346037-000	Cap, Aluminum, Black	6
7	51-515217-000	Screw, M5-.8 x 16, Stainless	2
8	51-515331-000	Screw, M6-1.0 x 30, Stainless	2
9	51-517110-000	Screw, M6-1.0 x 110, Stainless	1

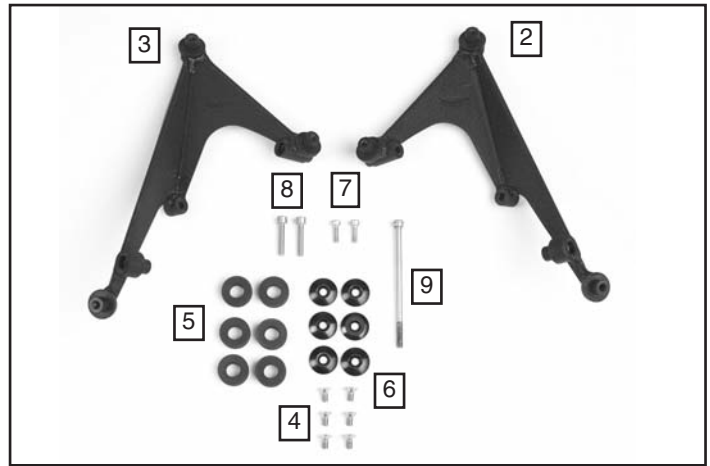

**PREPARATION and REMOVAL OF PARTS**

1. Position the motorcycle securely on its stand.
2. Remove the stock windshield and all parts shown in diagram A. Store parts, they will not be re-used. (8mm Box Wrench, 3mm, 5mm and 4mm Hex Key)

Ref.	Description
3	SCREEN, MLDG, LOW
4	SCREEN MOUNT BRKT, LH, MLDG
5	SCREEN MOUNT BRKT,RH,MLDG
6	SCREW,PAN/HD,TX,M6X1.0X12,SLV
8	BOLT,HHF,LGHTD,M6X1.0X16,SLV
9	SCREW,BUT/HD,M5X0.8X16,SLV
10	GROMMET,DIA20X3X6.2 ID
11	FLANGED SLEEVE, M5X7.0X6.3
12	LOCKNUT M5
13	O-RING ID5.6 X 2.2
14	MOUNT BRACKET,SCREEN,MOULDED
31	SCREW,BUT/HD,SKT,M5X0.8X8,SLV
32	SCREW,BUT/HD,M5X0.8X20,S/S

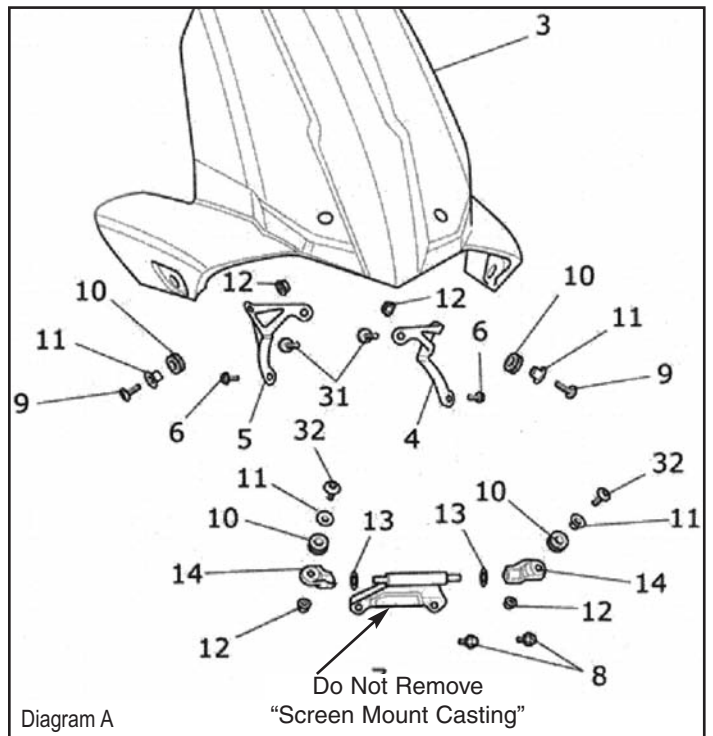

## PREPARATION and REMOVAL OF PARTS

3. Motorcycle is now ready for installation of your VStream Windshield. **Figure 1**

## INSTALLATION

1. Install one Grommet (5) into each hole on windshield. **Figure 2.**

2. Install Right Side Bracket at lower point with a 30mm Screw (8). Leave Loose. **Figure 3. (5mm Hex Key)**

3. Install Right Side Bracket at upper point with a 16mm Screw (7). Leave Loose. **Figure 4. (4mm Hex Key)**

4. Repeat steps 2 and 3 for Left Side Bracket



Figure 1

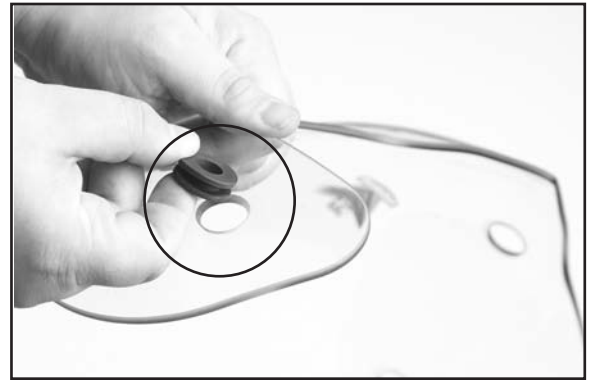

Figure 2



Figure 3

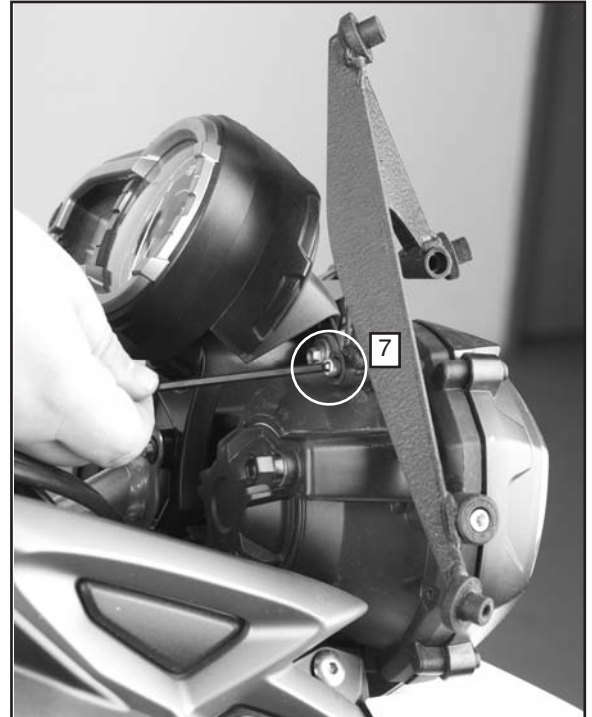

Figure 4

## INSTALLATION



Apply a small amount of anti seize or comparable product to the threads of item 9 prior to assembly.

5. Use the 110mm Screw (9) to join the Right and Left Bracket to the stock "Screen Mount Casting" as shown in **figure 5. Tighten fully. (5mm Hex Key)**

6. Fully tighten the 30mm and 16mm Screws on the Right and Left sides. **(5mm and 4mm Hex Key)**

7. Place Windshield on Mount Brackets. **Figure 6.**

8. Use one 12mm Screw (4) and Cap (6) to attach wind-screen to mounts. Repeat for all six holes. Tighten screws firmly. **Figure 7. (4mm Hex Key)**

9. **Check all clearances.** Turn fork to full left and right stop. Check clearances of mount brackets to motorcycle. Make any necessary adjustments.

10. Register your windshield. Page 4.

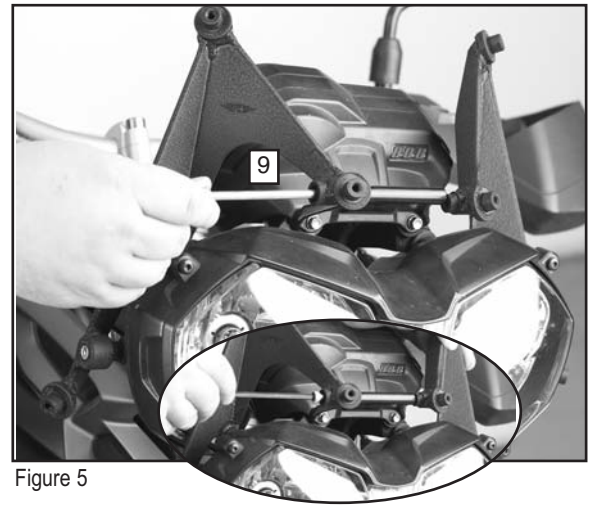

Figure 5



Figure 6



Figure 7

## MAINTENANCE

**Cleaning:** Wash with a clean soft cloth, plenty of warm water and, if necessary, a non-abrasive soap such as dishwashing liquid. Flannel or soft chamois make good cleaning cloths. Do not use rain protective products on the screen due to the solvent action of the alcohol in these products. Do not allow brake fluid, alcohol, or strong solvents to contact the screen.

National Cycle Windshield Wash Part number N1401-01 is good for everyday cleaning. Product is supplied with a handy travel size container and cloth for easy storage on the motorcycle.

## RAINZIP® TREATMENT

National Cycle's rain repellent treatment. RainZip treatment N1410-01 is safe for use on all motorcycle windshields and face shields.

Inquire with your local dealer or visit [www.nationalcycle.com](http://www.nationalcycle.com) to view an application video.

## ⚠ WARNING

Never ride your motorcycle with loose accessory mounting hardware. Check the hardware for tightness regularly.

Today's motorcycles are built with enough frame rigidity to withstand the moderate loads imposed on them by the foreseeable addition of an accessory(ies). If an accessory(ies) adversely affects your motorcycle's stability, immediately remove the accessory(ies). Do not ride a motorcycle that exhibits unsafe handling traits.

Have experienced service personnel correct any problem before riding with the accessory(ies) installed. For further questions concerning handling problems associated with an accessory(ies), contact your dealer, motorcycle manufacturer, or accessory manufacturer.

In rare circumstances, sunlight reflected off the inside curvature of windscreens can, at certain times of the day, cause extreme heat buildup on the motorcycle's instruments and possibly even melt them. Exercise care in parking to avoid this. Park facing the sun or place an opaque object over this area.

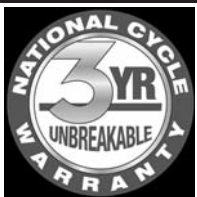

### National Cycle 3-Year Limited Warranty

Register your windshield on Line at: [www.nationalcycle.com/register.html](http://www.nationalcycle.com/register.html)  
or contact Customer Service at National Cycle, Inc. / PO Box 158 / Maywood, IL 60153 / USA 708/343/0400

National Cycle hereby warrants to the original registered owner of a National Cycle polycarbonate windshield for a period of three years from the date of purchase against breakage. This limited warranty is expressly limited to the replacement of the polycarbonate windscreen. This limited warranty does not include scratches, coating failure, cosmetic wear and tear, replacement of hardware, or any consequential damages or expenses including labor cost of installation, removal and/or replacement, inconvenience, inbound freight expenses or damage to any other component of the motorcycle or any other accessories. Certain chemicals, generally known as acidic hydrocarbons, are known to cause polycarbonate damage and will not be covered under this limited warranty. Please refer to the cleaning instructions supplied with all National Cycle windshields.

VStream® Wind protection products are covered by patent 7,387,328.

VStream® and National Cycle® are registered trademarks of National Cycle, Inc.