



Thank you for purchasing a National Cycle Product. Please read these instructions carefully and thoroughly before beginning work. Dealers, if installing this windscreen for a customer, please give them this manual. It contains information needed to properly maintain and use this product.



Attention:

Special notes and cautionary measures which can prevent damage to the accessory or motorcycle.



Note:

Tips for facilitation of operation, control and adjustment, as well as maintenance work.

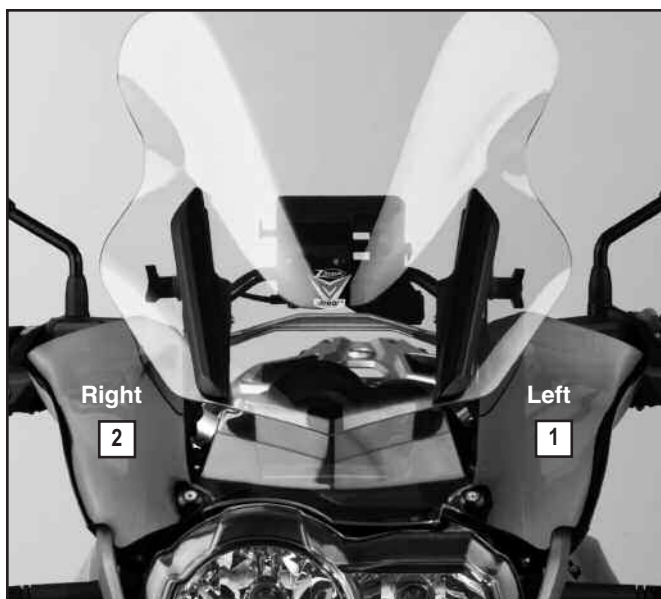

CONTENTS OF KIT

Item	Description	Part No.	Qty.
1	Winglet, Left	20-290550-000	1
2	Winglet, Right	20-290551-000	1
BAG#1248			
3	Cap	34-346048-000	6
4	Compression Limiter	34-349255-000	4
5	Screw, M5 x 25	51-514119-000	4
6	Screw, M5 x 16	51-514118-000	2
7	Washer, PSA	44-447635-000	6

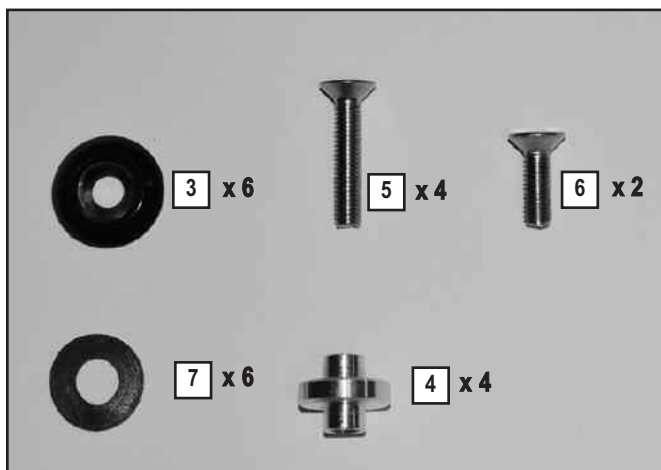

TOOLS REQUIRED:

T-25 Torx Wrench
3mm Hex Key

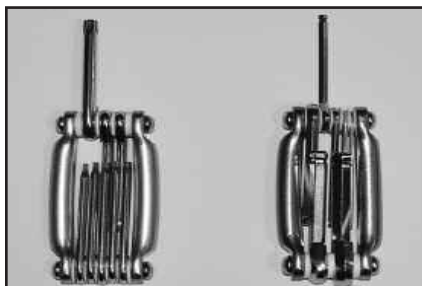



Figure 1



Figure 2

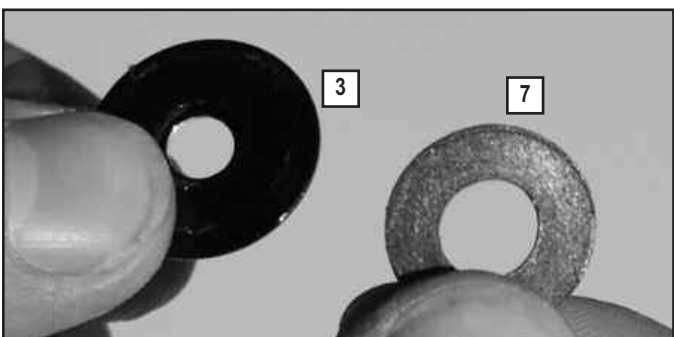

Figure 3

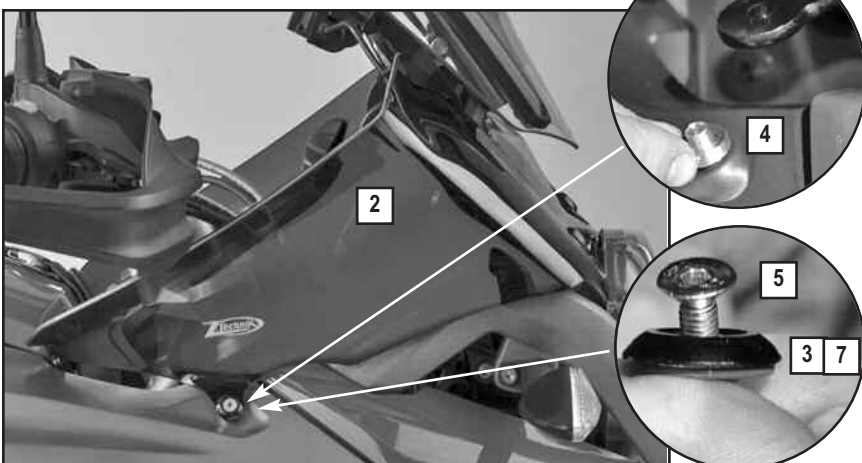

Figure 4

PREPARATION



Stock hardware removed will not be re-used.

1. Place motorcycle securely on its centerstand.

2. Remove the stock screws holding stock winglets. Remove winglets. Repeat on opposite side. Stock hardware will not be re-used. **(T25 Torx) Figure 1**

3. Remove the stock screw in side body panel. Repeat on opposite side. **(T25 Torx) Figure 2**

INSTALLATION

1. Remove protective mask from a Washer (7) and apply Washer to back side of Cap (3). Repeat process for all Washers (7) and Caps (3). **Figure 3**

2. Place one Compression Limiter (4) into the hole as shown in figure 4. **Figure 4**

Install Winglet at Side Location

3. Insert Screw (5) into Cap with Washer (3,7). Install Winglet (2) using this assembly. **(3mm Hex Key) Figure 4**

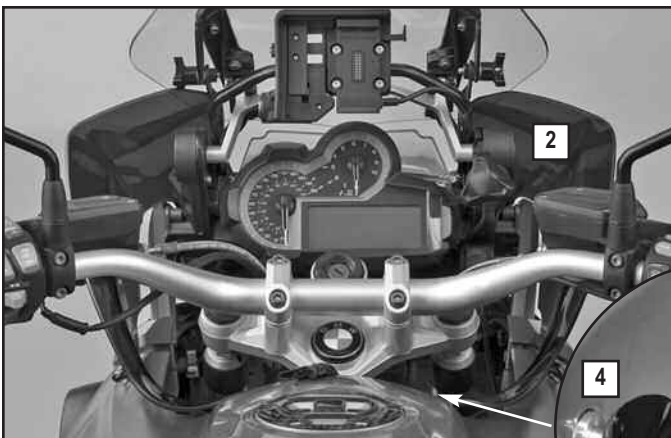
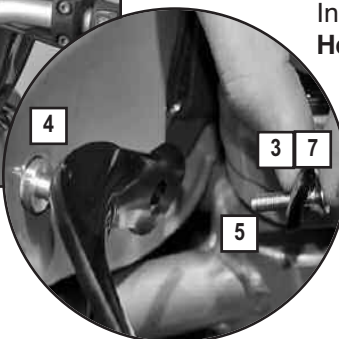

Figure 5



INSTALLATION

Install Winglet at Tank

4. Place one Compression Limiter (4) into the rear hole on tank as shown in figure 5. **Figure**

5. Insert Screw (5) into Cap with Washer (3,7). Install Winglet (2) using this assembly. **(3mm Hex Key) Figure 5**

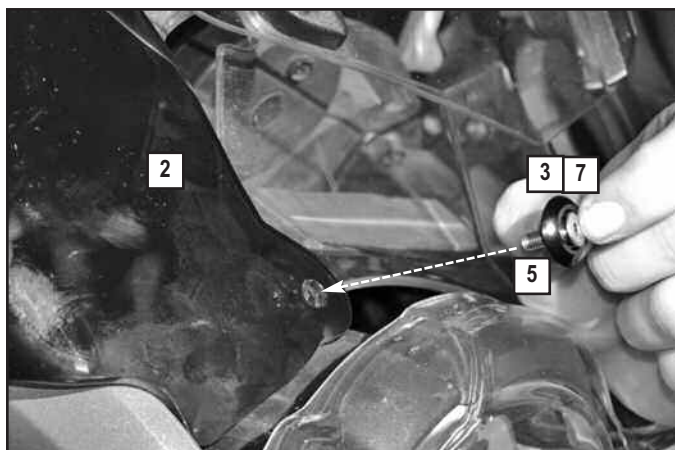

Figure 6

Install Winglet at Front

6. Insert Screw (6) into Cap with Washer (3,7). Install Winglet (2) using this assembly. **(3mm Hex Key) Figure 6**

7. Tighten the Screws (5 and 6) firmly. Do not over-tighten.

8. Repeat procedure on left side of motorcycle.



Finished Right Side View



Ask for Shield Wash™
and RainZip® at your
local dealer or visit
www.ztechnik.com.

CLEANING AND MAINTENANCE

To clean the screen, wash with a clean soft cloth, plenty of warm water and if necessary, a non-abrasive soap such as dishwashing liquid. Flannel or soft chamois make good cleaning cloths. Paint, glue residue or grease removal: Moisten cotton with naphtha or turpentine followed by a wash as above. National Cycle Shield Wash™ (N1401-01) makes a good daily cleaner and comes with a handy travel size bottle. Shield Wash is safe for all windshields and helmet visors.

Do not clean polycarbonate in hot sun or high temperatures. Do not clean the screen with glass cleaners.

Do not allow brake fluid, alcohol, or strong solvents to contact the screen.

RAIN REPELLENT

Do not use rain protective products made for automotive glass. We recommend National Cycle's RainZip® (N1410-01) to keep your windscreen clear in rainy weather.

! WARNING

Never ride your motorcycle with loose accessory mounting hardware. Check the hardware for tightness regularly.

Today's motorcycles are built with enough frame rigidity to withstand the moderate loads imposed on them by the foreseeable addition of an accessory(ies). If an accessory(ies) adversely affects your motorcycle's stability, immediately remove the accessory(ies). Do not ride a motorcycle that exhibits unsafe handling traits.

Have experienced service personnel correct any problem before riding with the accessory(ies) installed. For further questions concerning handling problems associated with an accessory(ies), contact your dealer, motorcycle manufacturer, or accessory manufacturer.