

## Installation Instructions

### N763A Chrome Lower Deflectors for Heavy Duty™ Windshields with CJ-Series, J-Series and B-Series Mount Kits

Thank you for purchasing a National Cycle product. Read these instructions carefully and thoroughly before beginning work. Dealers, if installing this product for a customer, please give them this manual upon completion. It contains information needed to properly maintain and use this product.

Description:	Chrome Lower Deflectors	Model:	Varies
Part Number:	N763A	Installation Time:	20-30 min.

#### N763A PARTS LIST

ITEM	PART NO.	DESCRIPTION	QUANTITY
A	30-307626-000	Lower Deflector, Right	1
B	30-307625-000	Lower Deflector, Left	1



**ATTENTION:** Special notes and cautionary measures which can prevent damage to the accessory or vehicle.



**NOTE:** Tips for facilitation of operation, control and adjustment, as well as maintenance work.

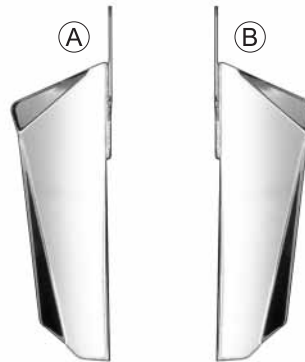

#### TOOLS REQUIRED FOR ASSEMBLY

5/32" Hex Key  
7/16" Wrench

#### PREPARATION

- If the front turn signals are mounted to the fork tubes with a clamp, loosen the clamp and slide the turn signals up to the upper Fork Crown.
- If Step 1 is not possible, consult your dealer or National Cycle Customer Service for National Cycle's Turn Signal Relocation Brackets 37-372100-000.
- Prepare the Fork Clamps from your Windshield Mounting Kit as described in the Mounting Kit Installation Instructions with the rubber clamp spacers.



**Note:** If your Windshield and Mount Kit were installed previous to your purchase of our Chrome Lower Deflectors, follow the procedure below.

- Loosen and remove the Windshield Mount Screws, Nuts and Flat Bracket and/or Spacers from one side only (see *Illustration A on page 2*). The Fork Clamp on the opposite side will hold the Windshield relatively stable in its current height position.
- Hold the Fork Clamp in position and insert that side's Chrome Lower Deflector between the Fork Clamp and the Windshield's Mount Bracket.
- Put a 1/2" Button Head Screw through both middle holes in the Deflector and through the middle holes of the Fork Clamp. Start a nut on each screw and tighten until snug. (5/32" Hex Key, 7/16" Wrench)
- Reinstall the upper and lower Mounting Bolts through the Windshield's Mount Bracket, the Chrome Lower Deflector and the Fork Clamp, using the Flat Bracket and/or Spacers specific to your Kit. Start a nut on each screw and tighten until snug. (7/16" Wrench)
- Repeat procedure on the opposite side.
- Tighten all fasteners as specified in the original Windshield Mounting Kit Installation Instructions.

#### INSTALLATION



**Note:** An assistant is helpful for final Windshield installation.

- Assemble the Fork Clamps onto the fork tubes per the instructions that came with your Mount Kit.
- Hold the appropriate Lower Deflector in position against the Fork Clamp (see *Illustration A on page 2*).
- Put a 1/2" Button Head Screw through both middle holes in the Deflector and through the middle holes of the Fork Clamp. Start a nut on each screw and tighten until snug. (5/32" Hex Key, 7/16" Wrench)
- Repeat Steps 3 on the opposite side Fork Clamp.
- Before proceeding, verify that the Lower Deflectors do not interfere with the fork's ability to turn to the full stops in both directions.
- Install the Windshield according to the instructions provided with the Windshield Mounting Kit, using the appropriate Flat Brackets and/or Spacers specific to your Kit. (7/16" Wrench)
- After final adjustments are complete, tighten all fasteners as specified in the original Windshield Mounting Kit Installation Instructions.

Illustration A

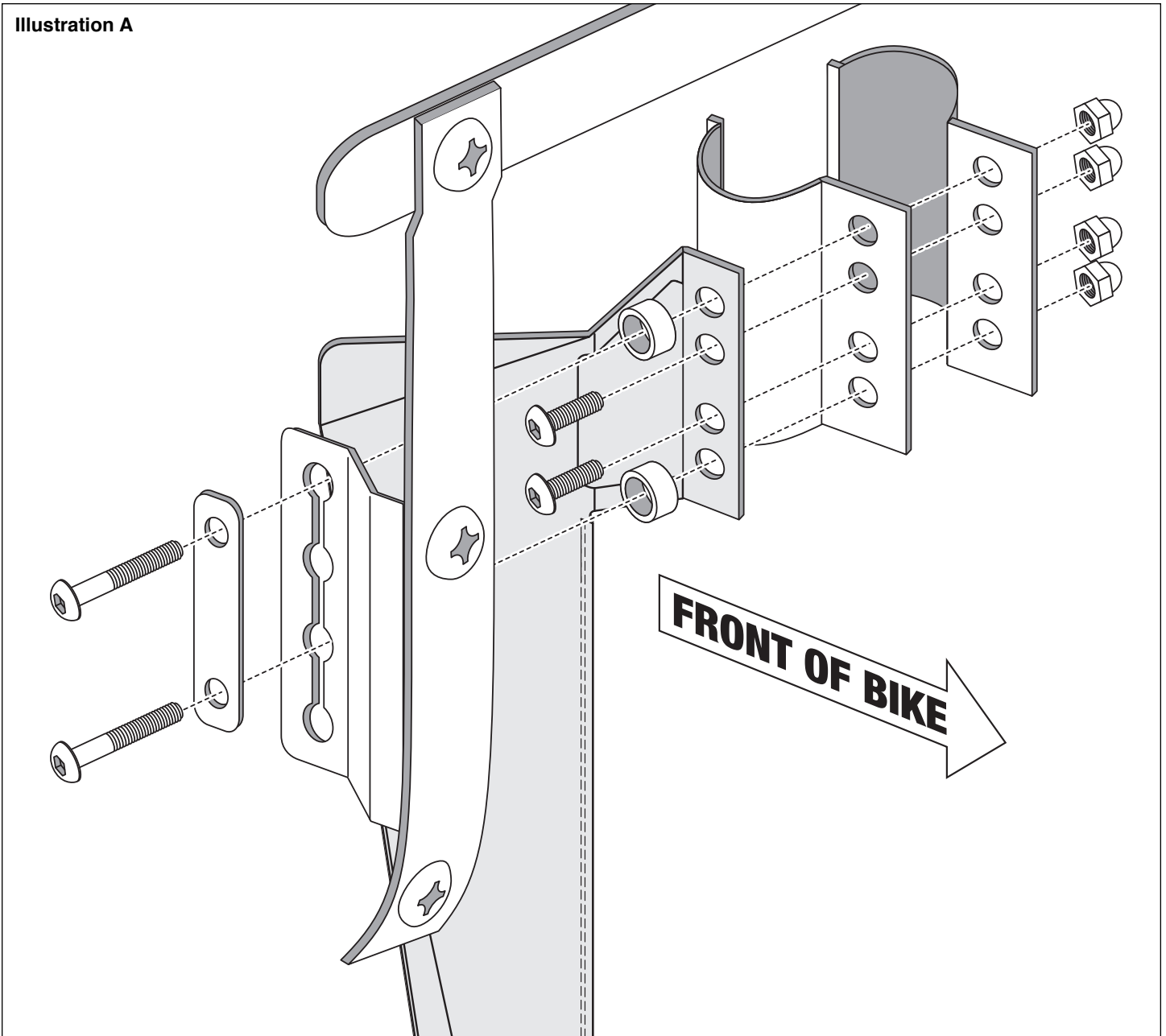

 **WARNING**

Never operate your vehicle with loose accessory mounting hardware. Check the hardware for tightness regularly.

Motorcycles are built with enough frame rigidity to withstand the moderate loads imposed on them by the foreseeable addition of an accessory(ies). If an accessory(ies) adversely affects your vehicle's stability, immediately remove the accessory(ies). Do not operate a vehicle that exhibits unsafe handling traits.

Have experienced service personnel correct any problem before driving with the accessory(ies) installed. For further questions concerning handling problems associated with an accessory(ies), contact your dealer, motorcycle manufacturer, or accessory manufacturer.

